



130-101-FO – Snap Back Slider Lock shown with 130-06 Snap Back Keeper



130-201-FO – Flush Back Slider Lock shown with 130-88 Flush Back Keeper

MATERIALS AND FINISH:

Slider Lock Keeper, Slider Lock case, lever and locking hook made of die cast zinc. Slider locking spring made of strengthened steel with a zinc coating. Finished with an ultra durable powder coat, protects against rust and UV rays.

ORDERING INFORMATION

1. Choose desired color and style of slider lock, Snap Back or Flush Back (indicate by part number.)
2. Specify orientation of lock mechanism, indicated by last 2 digits of part number.
 - OF for right hand
 - FO for left hand

(Note: slider lock keepers are non-handed, useable as either left or right.)
3. Specify quantity desired. Minimum order 1 box and multiples thereof.

Packaging: 200 slider locks / box

Weight: see specification sheets for weight of box

Packaging: 1000 (5x200) slider lock keepers / box

Weight: see specification sheets for weight of box

STANDARD COLORS:

Available colors are white and beige, custom colors available upon request (some conditions may apply).

Color Code:

- 130-xxx = Ivory White
- 132-xxx = White
- 136-xxx = Beige

SELECT ADDITIONAL COMPONENTS.

Recommended:

- Slider Wheel – refer to Slider Window Rollers section

LIFETIME WARRANTY

All Acme Window Hardware Ltd. Components are provided with a lifetime warranty, please see Warranty section for full details

Flushback Sash Locks & Keepers

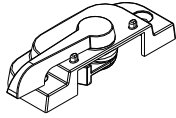

Unlock Position - Right Hand Shown

Part Number	Model	Orientation
132-200	200	RH
132-201	201	LH

Color Number Codes:
 130 = Ivory White
 132 = White
 136 = Beige

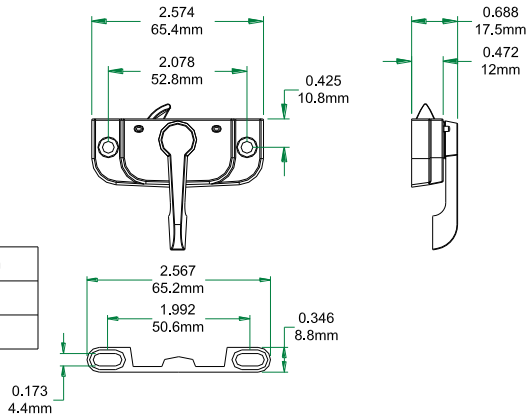

Snapback - Sash Locks & Keepers

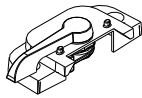

Unlock Position - Right Hand Shown

PART NUMBER	MODEL	Orientation
132-100	100	RH
132-101	101	LH

Color Number Codes:
 130 = Ivory White
 132 = White
 136 = Beige

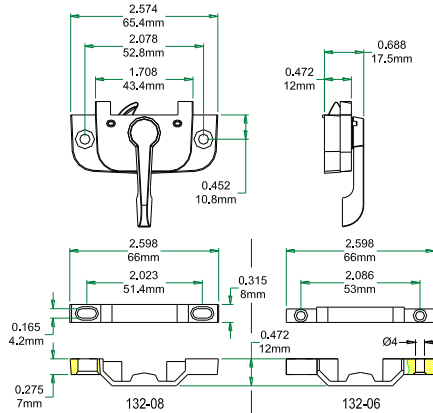

Sash Locks & Keepers

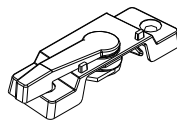

Unlock Position - Right Hand Shown

Part Number	Model	Orientation
132-220	220	RH
132-221	221	LH

Color Number Codes:
 130 = Ivory White
 132 = White
 136 = Beige

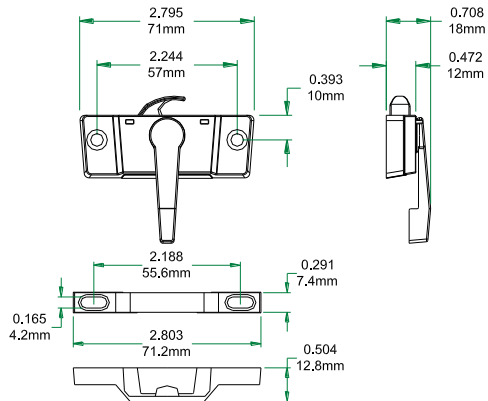



2035-2 – Slider Wheel 14mm (double chrome)



2012 – Slider Wheel 12mm

MATERIALS AND FINISH:

Roller housing constructed of high strength, high density nylon.
Milled copper wheels with chrome plating.

ORDERING INFORMATION

1. Choose desired style and size of Slider Wheel (indicate by part number.)
2. Specify quantity desired. Minimum order 1 box and multiples thereof.

Packaging: 1000 (5x200) Slider Wheels / box

Weight: see specification sheets for weight of box

LIFETIME WARRANTY

All Acme Window Hardware Ltd. Components are provided with a lifetime warranty, please see Warranty section for full details

- 2001 Snap In Slider Wheel Chromed - Low Setting; A= 2.6mm (0.102")
- 2001-H Snap In Slider Wheel Chromed - High Setting A= 3.25mm (0.127")

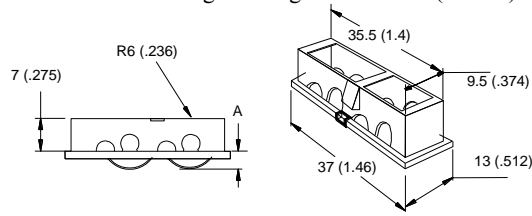

- 2012 Slider Wheel 12mm A = 12mm (0.472")
- 2014 Slider Wheel 14mm A = 14mm (0.551")
- 2018 Slider Wheel 14mm A = 18mm (0.708")

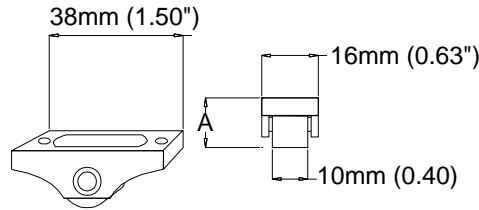

- 2035 Slider Wheel Double Roller - 14mm – Brass
- 2035-2 Slider Wheel Double Roller - 14mm - Chromed

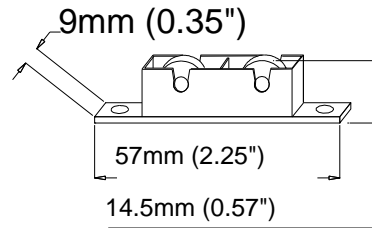

- 2038 Snap In Slider Wheel 14.5 mm - Chromed

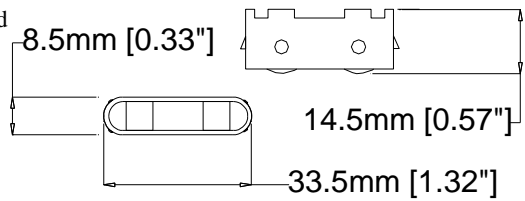

- 206500 Concave Double Wheels - Chromed

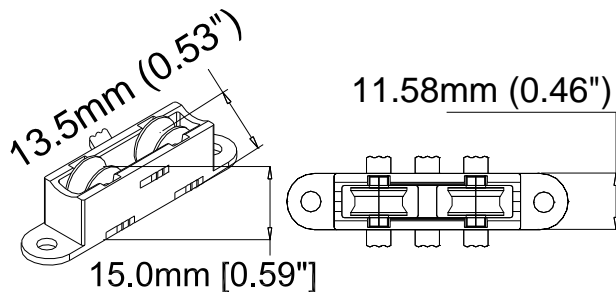



20-015-R – Tilt Latch (R/H)

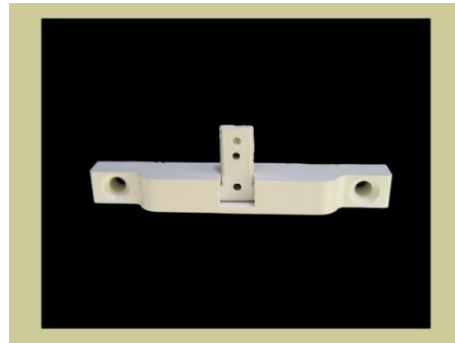

2050 – Night Latch

MATERIALS AND FINISH:

Tilt Latch made of high strength, high density nylon housing, utilizing steel springs with long-lasting elasticity. Night Latch made of high strength, high density nylon with steel reinforced core.

ORDERING INFORMATION

1. Choose desired components (indicate by part number).
2. Specify orientation of tilt latch, indicated by last digit of part number.
 - R for right hand
 - L for left hand(Note: night latches are non-handed, useable as either left or right.)
3. Specify quantity desired. Minimum order 1 box and multiples thereof.

Packaging:

200 tilt latches / box

Weight: 1Kg / box

Packaging:

1000 (5x200) night latches / box

Weight: 5Kg / box

LIFETIME WARRANTY

All Acme Window Hardware Ltd. Components are provided with a lifetime warranty, please see Warranty section for full details

- 20-015-L Tilt Latch - Left
- 20-015-R Tilt Latch - Right

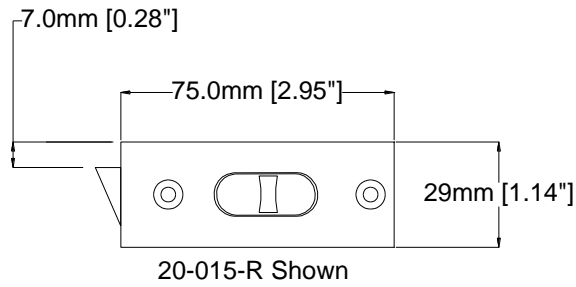

- 2050 Night Latch – Steel Reinforced

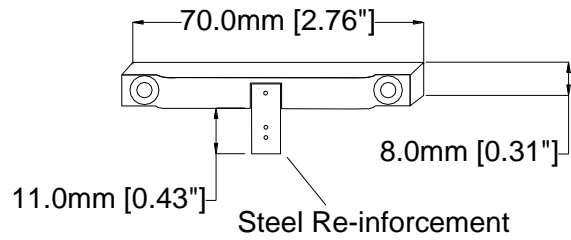



130-504 – Multi Lock Handle – Ivory White

MATERIALS AND FINISHING:

Constructed of high quality die cast zinc. Ultra durable powder coat finish, protects against rust and UV rays.

ORDERING INFORMATION

1. Choose desired color (indicate by part number.) Handles are useable as either left or right (non-handed)
2. Specify quantity desired. Minimum order 1 box and multiples thereof.

Packaging: 100 locks / box

Weight: 17Kg / box

3. **SELECT ADDITIONAL COMPONENTS.**

Recommended:

- Keeper – for single, and multi point lock system
Refer to Keeper section
- Tie Bar – if application is multi point lock system
Refer to Tie Bar section

RECOMMENDED SCREW TYPE:

- Truss head #8 x 3/8 - Socket-type B

STANDARD COLORS:

Available colors are white and beige, custom colors available upon request (some conditions may apply).

Color Code:

- 130-xxx = Ivory -White
- 132-xxx = White
- 136-xxx = Beige

LIFETIME WARRANTY

All Acme Window Hardware Ltd. Components are provided with a lifetime warranty, please see Warranty section for full details

LOCKING HANDLES:

- 130-504 – Ivory White
- 132-504 – White
- 136-504 - Beige.

TO USED WITH MULTI-POINT

LOCKS TIE BAR SERIES:

- 192-xxxx - Rollers Adj. tie bar
- 197-xxxx – SST Rollers Adj. tie bar
- 198-xxxx – SST Rollers Adj. tie bar - C/w Lever pin
- 200-xxxx – SST Rollers Adj. tie bar
- 7200-xxxx – SSS Tie bars

WITH SINGLE-POINT LOCK KEEPERS:

- 19065 – Adj. Keeper W/tab
- 19067 – Adj. Keeper W/tab
- 19068 – Adj. Keeper W/out tab
- 7067- Adj. Keeper W/tab SST
- 7068 – Adj. Keeper W/out tab SST

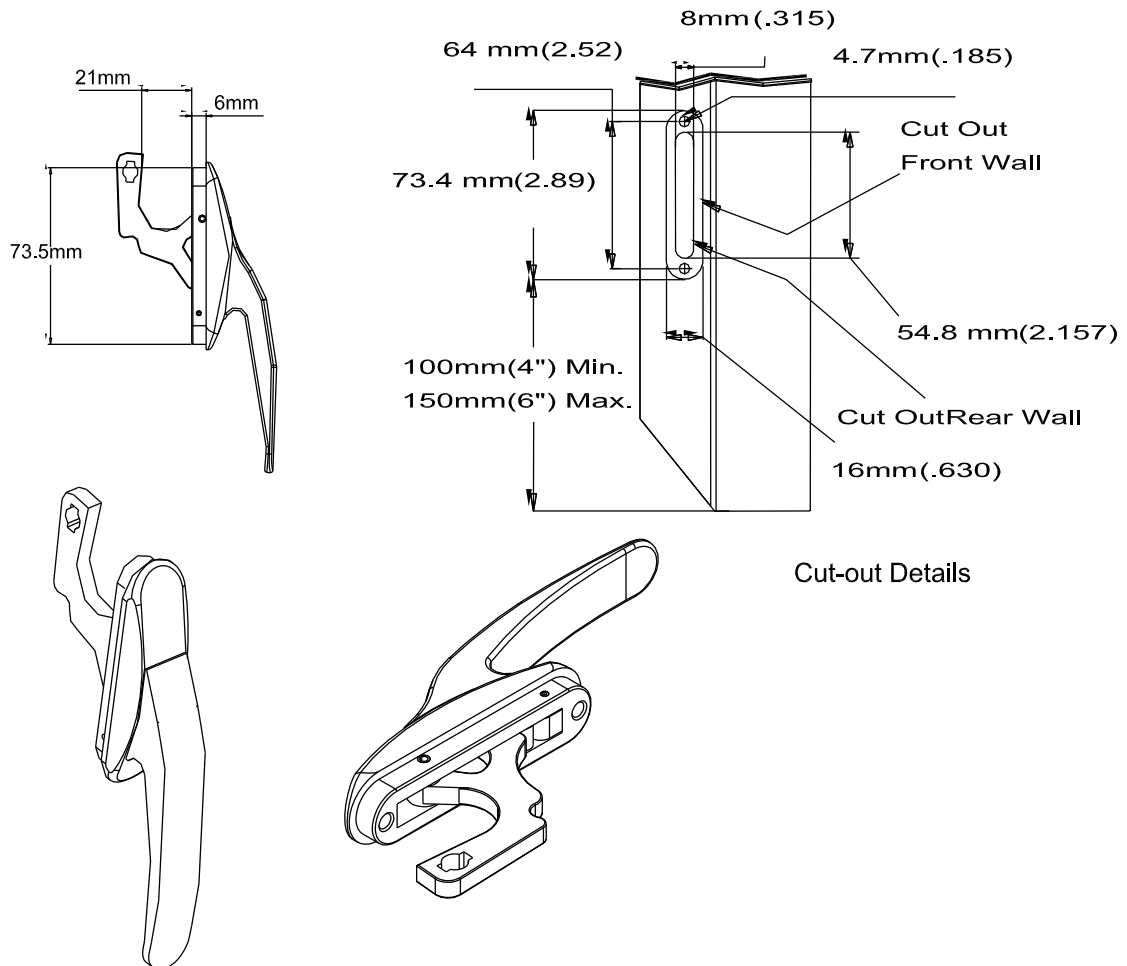

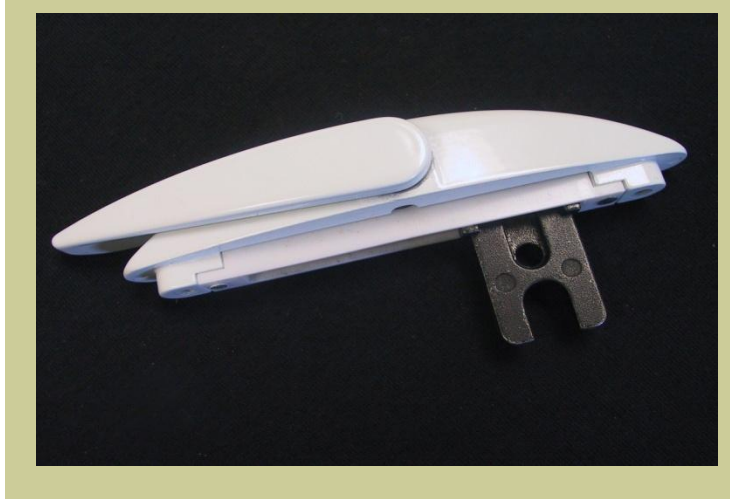

130-516 – Multi Lock Handle - EU White

MATERIALS AND FINISHING:

Constructed of high quality die cast zinc. Ultra durable powder coat finish, protects against rust and UV rays.

ORDERING INFORMATION

1. Choose desired color (indicate by part number.) Handles are useable as either left or right (none-handed)
2. Specify quantity desired. Minimum order 1 box and multiples thereof.

Packaging: 100 locks / box

Weight: 15Kg / box

SELECT ADDITIONAL COMPONENTS.

Recommended:

- Keepers : multi point lock system
Refer to Keeper section
- Tie Bar – this application is multi point lock system Refer to Tie Bar section

RECOMMENDED SCREW TYPE:

Truss head #8 x 3/8 - Socket-type B

STANDARD COLORS:

Available colors are white and beige, custom colors available upon request (some conditions may apply).

Color Code:

- 130-xxx = Ivory White
- 132-xxx = White
- 136-xxx = Beige

LIFETIME WARRANTY

All Acme Window Hardware Ltd. Components are provided with a lifetime warranty, please see Warranty section for full details

Grande Multit/Single Point Locking Handle

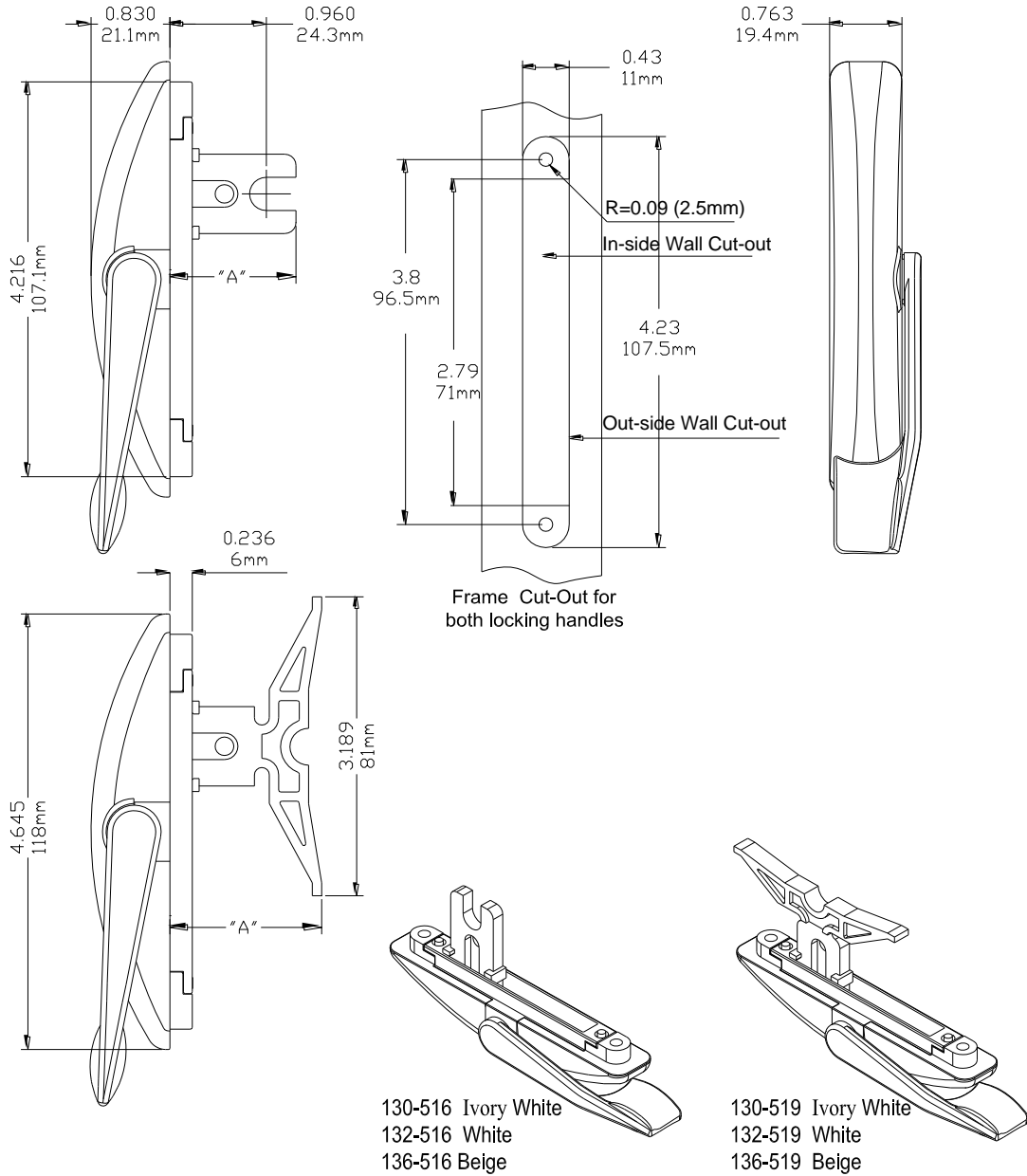



130-511 – Multi Lock Handle – Ivory White - None Handed



RECOMMENDED SCREW TYPE:

Truss head #8 x 3/8 - Socket-type B

MATERIALS AND FINISHING:

Constructed of high quality die cast zinc. Ultra durable powder coat finish, protects against rust and UV rays.

ORDERING INFORMATION

1. Choose desired color (indicate by part number.)
Handles are useable as either left or right.
2. Specify quantity desired. Minimum order 1 box and multiples thereof.
Packaging: 100 locks / box
Weight: 25Kg / box
3. Select additional components.
Recommended:
 - Keeper – for single, and multi point lock system
Refer to Keeper section
 - Tie Bar – if application is multi point lock system
Refer to Tie Bar section

STANDARD COLORS:

Available colors are white and beige, custom colors available upon request (some conditions may apply).

Color Code:

- 130-xxx = Ivory White
- 132-xxx = White
- 136-xxx = Beige

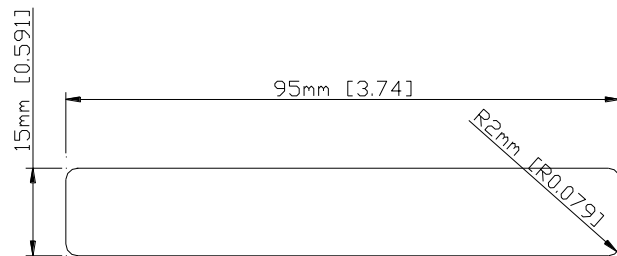

Cut out through 2 walls

LIFETIME WARRANTY

All Acme Window Hardware Ltd. Components are provided with a lifetime warranty, please see Warranty section for full details

TO USED WITH MULTI-POINT
LOCKS TIE BAR SERIES:

- 192-xxxx - Rollers Adj. tie bar
- 197-xxxx – SST Rollers Adj. tie bar
- 198-xxxx – SST Rollers Adj. tie bar - C/w Lever pin
- 200-xxxx – SST Rollers Adj. tie bar
- 7200-xxxx – SSS Tie bars



Link Arm

- 19082 – Link Arm - Left
- 19083 – Link Arm - Right

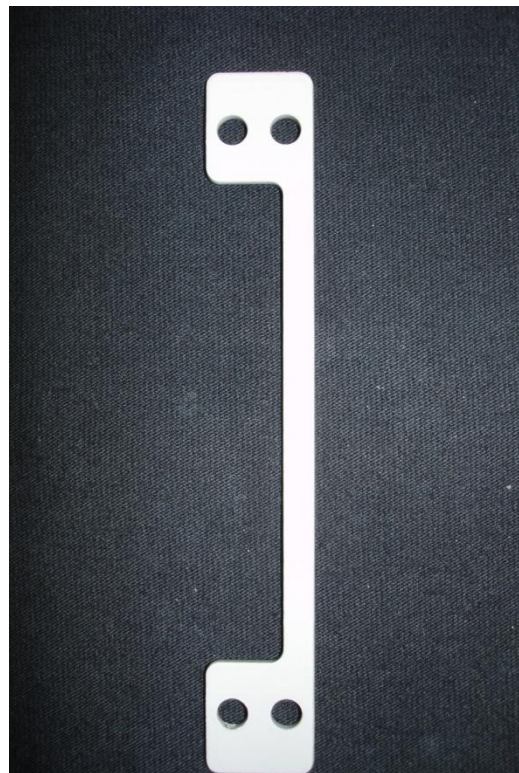

Supporting Plate

- 19020 – Supporting Plate



20550 – Multi Lock Keeper

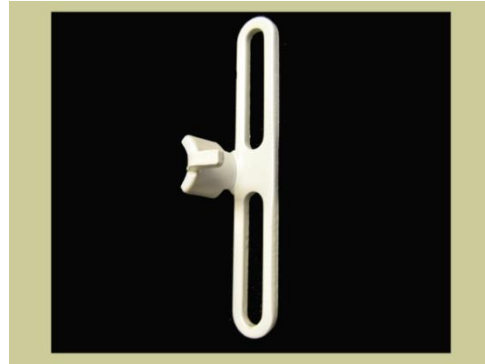

19065 – Awning Keeper w/tab

MATERIALS AND FINISH:

Multi Lock Keepers are made of high strength, high density nylon or strengthened steel with an ultra durable powder coat finish, protects against rust and UV rays.

Awning Keepers are available in stainless steel or strengthened steel with an ultra durable powder coat finish, protects against rust and UV rays.

ORDERING INFORMATION

1. Choose keeper based on application. Keepers are non-handed, useable as either left or right.
2. For single point lock system: Choose powder coat or stainless steel finish Awning Keeper (indicate by part number).

For multi point lock system: Choose keeper based on type of Tie Bar

Packaging: 1000 (5x200) keepers / box

Weight: see specification sheets for weight of box
Specify quantity desired.

Minimum order 1 box and multiples thereof.

1. 20550 Multi Lock Keeper – use with Adjustable Tie Bar (Series 192; 197 and 198) or Standard Tie Bar (Series 190)
2. 19065 Awning Keeper w/tab – use with Multi Lock Handle (132-504 and 132-519)

LIFETIME WARRANTY

All Acme Window Hardware Ltd. Components are provided with a lifetime warranty, please see Warranty section for full details

TIE BAR SERIES: 192 - 197 - 198 - 200 & 7200

- 19050 – Keeper (Tie bar series 190 Only)
- 20550 – Keeper (Tie bar series 192 - 197 - 198 - 200 & 7200)
- 20052 - Keeper (Tie bar Series 192 - 197 - 198 - 200 & 7200)
- 204610 - Keeper (Tie bar Series 192 - 197 - 198 - 200 & 7200)

19050 – Keeper (Tie bar series 190 Only)

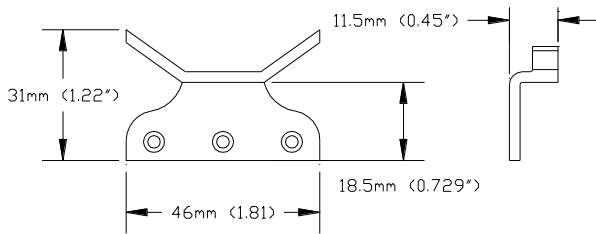

204610:

(Tie bar Series 192-197-198-200 & 7200)

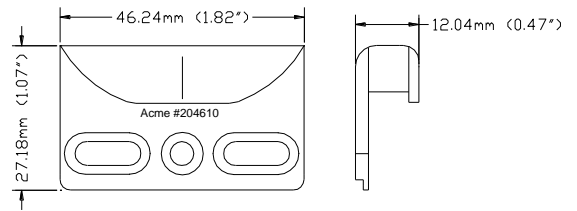

20550 – Keeper:

(Tie bar Series 192-197-198-200 & 7200)

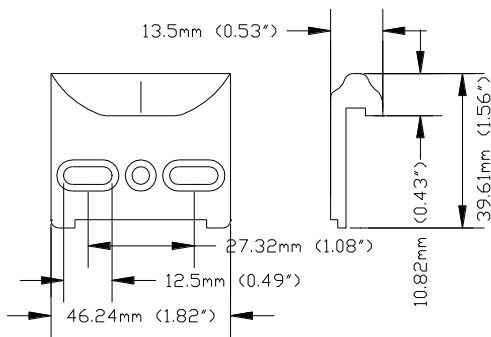

20052 – Keeper:

(Tie bar Series 192-197-198-200 & 7200)

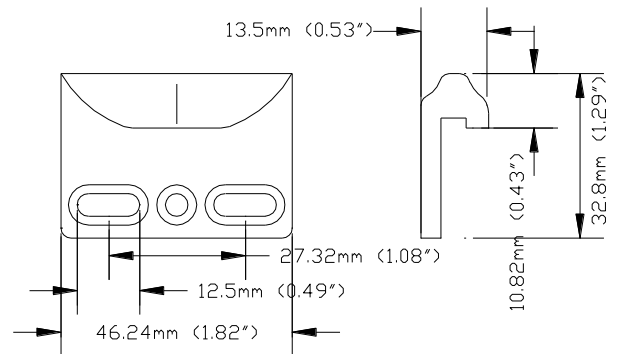

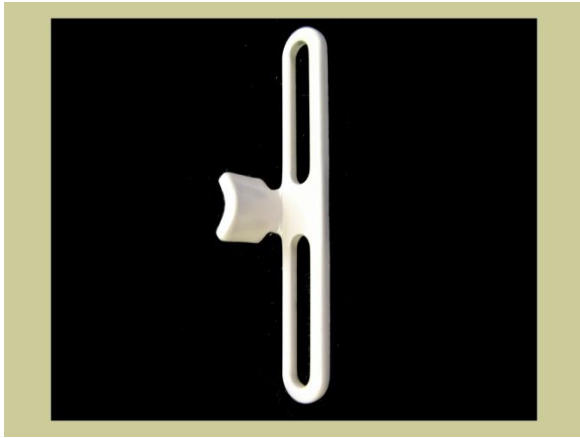

19068 – Awning Keeper w/o tab



19050 – Multi Lock Keeper



19430 – Cone Tie Bar Keeper (L/H)



1962040 – Interlock Keeper (L/H)

KEEPERS

1. 19068 Awning Keeper w/o tab – use with Multi Lock Handle (132-504)
2. 19050 Multi Lock Keeper – use with Standard Tie Bar (Series 190)
3. 19430 Cone Tie Bar Keeper – use with Cone Tie Bar (Series 194)
4. 1962040 Interlock Keeper – use with Interlock Tie Bar (Series 196)

LIFETIME WARRANTY

All Acme Window Hardware Ltd. Components are provided with a lifetime warranty, please see Warranty section for full details

SINGLE-POINT LOCK KEEPERS:

19065 – Adj. Keeper W/Tab

19067 – Adj. Keeper W/Tab

19068 – Adj. Keeper W/Out Tab

7067- Adj. Keeper W/Tab - Stainless Steel - (Spec. same as #19067)

7068 – Adj. Keeper W/Out Tab - Stainless Steel - (Spec. same as #19068)

19065 Keeper W/Tab: A =18mm (0.708)

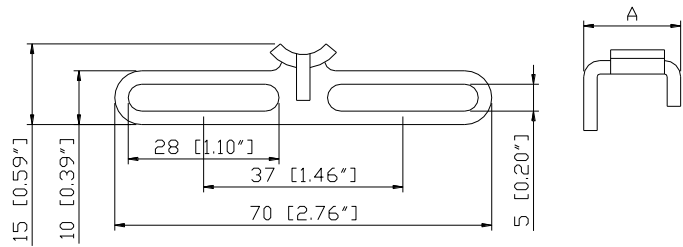

19067 Keeper W/Tab: A =15mm (0.590)

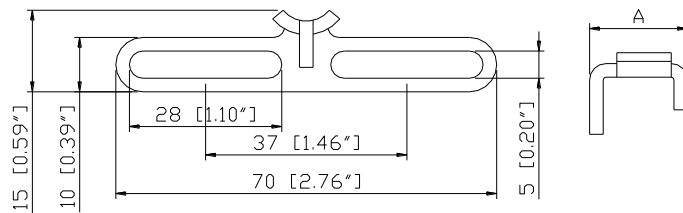

19068 Keeper W/Out Tab: A =15mm (0.590)

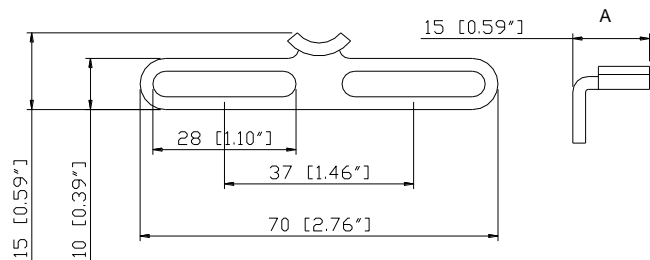



132-678 or 132-7777 Awning Lever Lock & Keeper



132-679 – Awning Hanger Hinges (face mount)



132-680 or 132-7800 Awning Hanger Hinges (side mount)

MATERIALS AND FINISH:

1. 132-678; 132-679; -132-680 = Steel - Powder Coat Finished
2. 132-7777; 132-7800 = Stainless Steel – Powder Coat Finished

Awning Lever Lock, Keeper, and Awning Hanger Hinges are constructed of strengthened steel or with stainless steel; all with an ultra durable powder coat finish, protects against rust and UV rays. Come in white and beige colors.

ORDERING INFORMATION

1. Choose desired components (indicate by part number/colors)
For face mounted hinges select 132-679 - White; 136 = Beige
For side mounted hinges select 132-680/132-7800 White; 136 = Beige
2. Specify quantity desired. Minimum order 1 box and multiples thereof.

Packaging: 1000 5x200)

Lever Lock & Keepers/box

Weight: 20Kg / box

Packaging: 1000 (5x200) Hopper Hinges- Pair / box

Weight: 20Kg / box

STANDARD COLORS:

Available colors are white and beige, custom colors available upon request (some conditions may apply).

Color Code:

- 130 = Ivory White
- 132 = White
- 136 = Beige

LIFETIME WARRANTY

All Acme Window Hardware Ltd. Components are provided with a lifetime warranty, please see Warranty section for full details

- 130-678 or 130-7777 (SST) Awning Lever Lock & Pocket Keeper – Ivory White
- 132-678 or 132-7777 (SST) Awning Lever Lock & Pocket Keeper - White
- 136-678 or 136-7800 (SST) Awning Lever Lock & Pocket Keeper - Beige

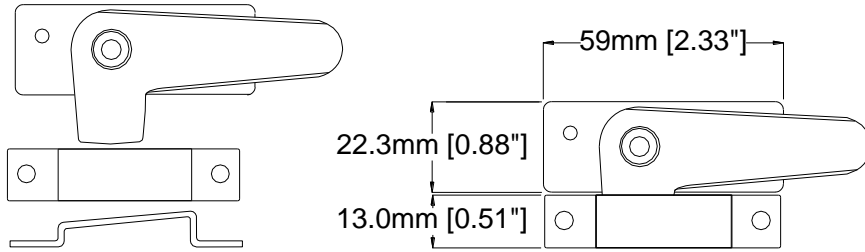

- 130-679 Hopper Hinge – Face-mount - Ivory White
- 132-679 Hopper Hinge – Face-mount - White
- 136-679 Hopper Hinge – Face-mount - Beige

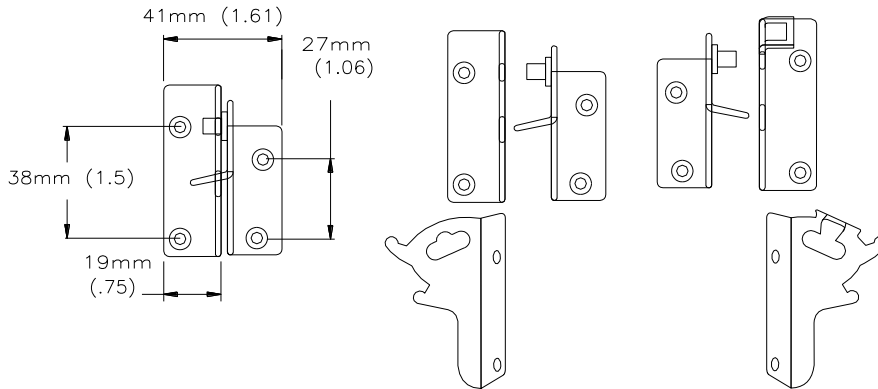

- 130-680 or 130-7800 (SST) Hopper Hinge – Side-mount - Ivory White
- 132-680 or 132-7800 (SST) Hopper Hinge – Side-mount - White
- 136-680 or 136-7800 (SST) Hopper Hinge – Side-mount - Beige

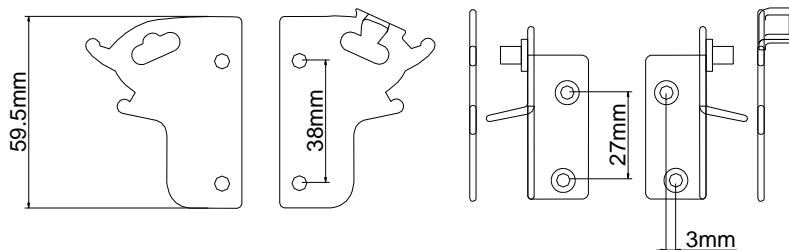

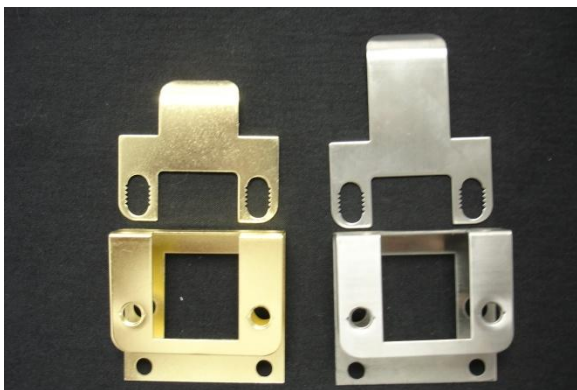

Single In- Swing Door Strike Plate

Single Out- Swing Door Strike Plate

MATERIALS AND FINISH:

Available in either brass finished or stainless steel.

ORDERING INFORMATION

1. Choose desired finish, brass or stainless steel along with swing direction (indicate by part number.)
2. Choose style of strike, single or double.
 -6000 series for single strike style
 -4000 & 5000 series for double strike style
3. Specify quantity desired. Minimum order 1 box and multiples thereof.

Packaging:

- 100 Door Strike Plates / box

Weight:

- Single strike style: 10Kg / box
- Double strike style; 19Kg / box

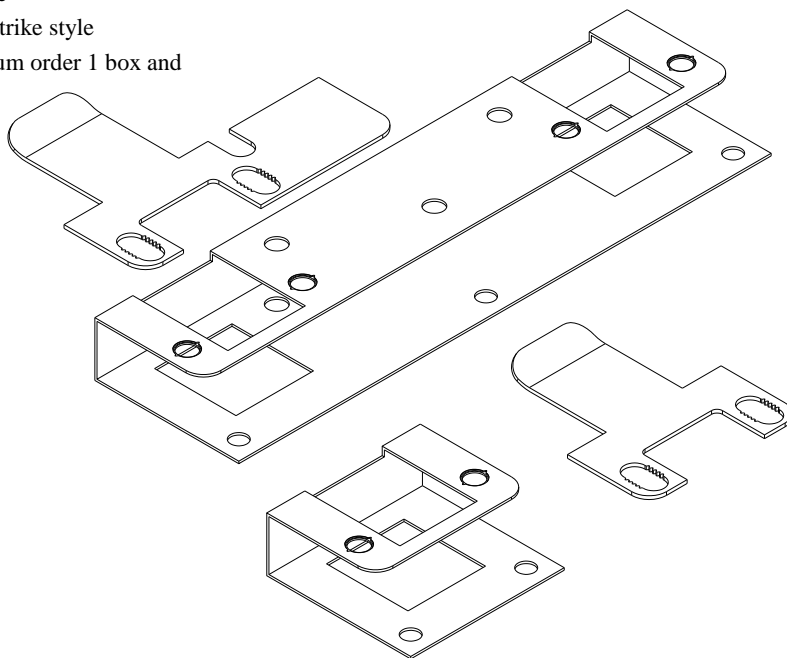

LIFETIME WARRANTY

All Acme Window Hardware Ltd. Components are provided with a lifetime warranty, please see Warranty section for full details

Double Door Striker Plates

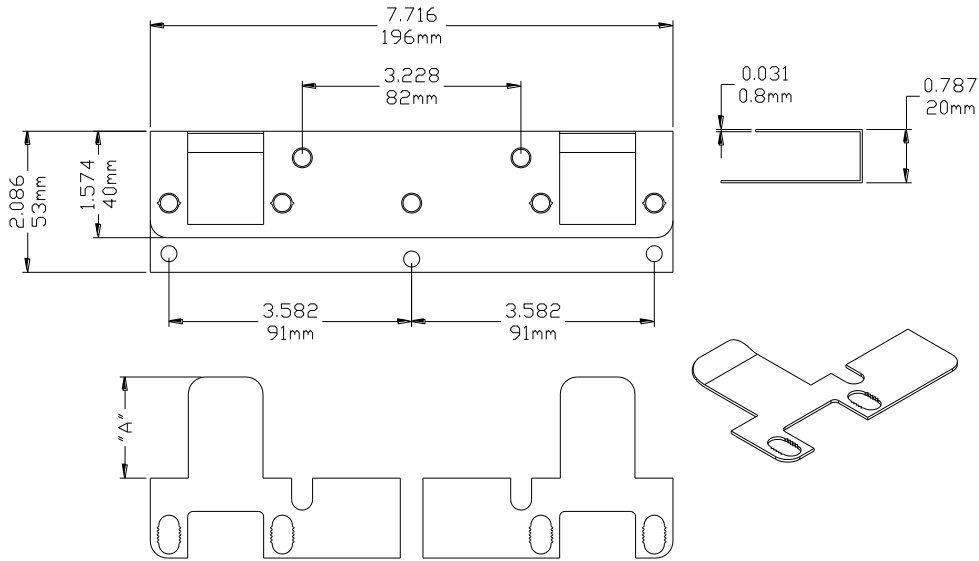

Product Name	Part Number	" A "	Material	Type
OutSwing Double Door Striker	4440	1.496"	SST	
InSwing Double Door Striker	4441	0.787"	SST	
OutSwing Double Door Striker	5550	1.496"	Steel	Brass Finishing
InSwing Double Door Striker	5551	0.787"	Steel	Brass Finishing

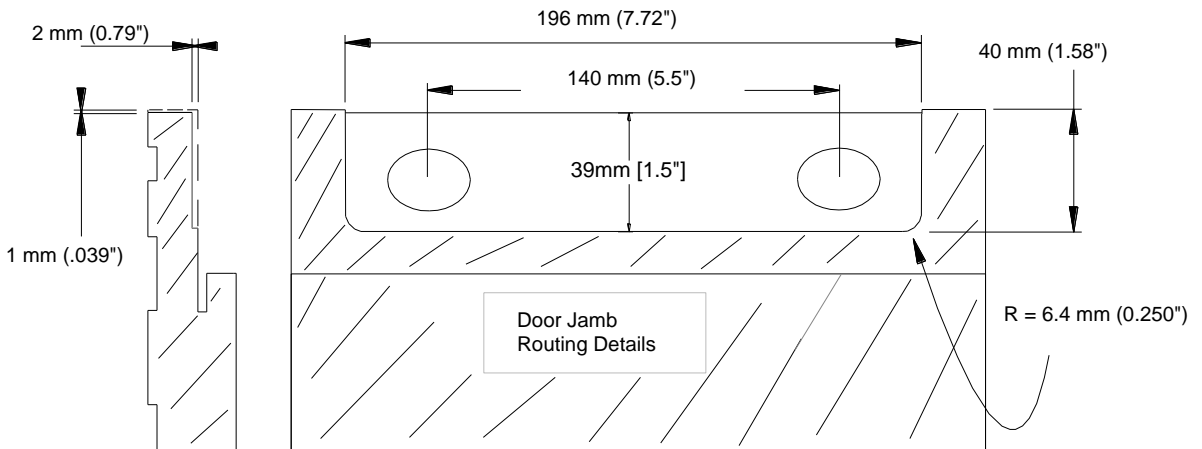

Single Door Striker Plates

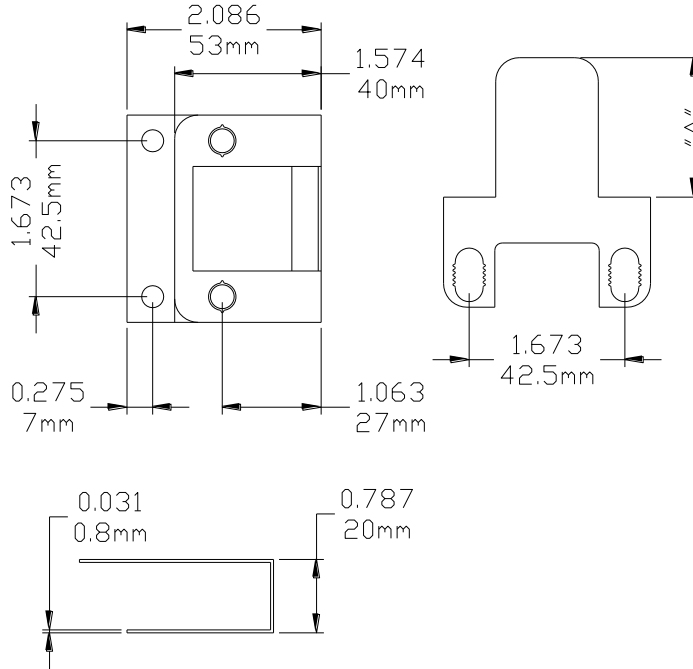

Product Name	Part Number	" A "	Material	Type
OutSwing Single Door Striker	6660	1.496"	Steel	Brass Finishing
InSwing Single Door Striker	6661	0.787"	Steel	Brass Finishing
OutSwing Single Door Striker	7770	1.496"	SST	
InSwing Single Door Striker	7771	0.787"	SST	

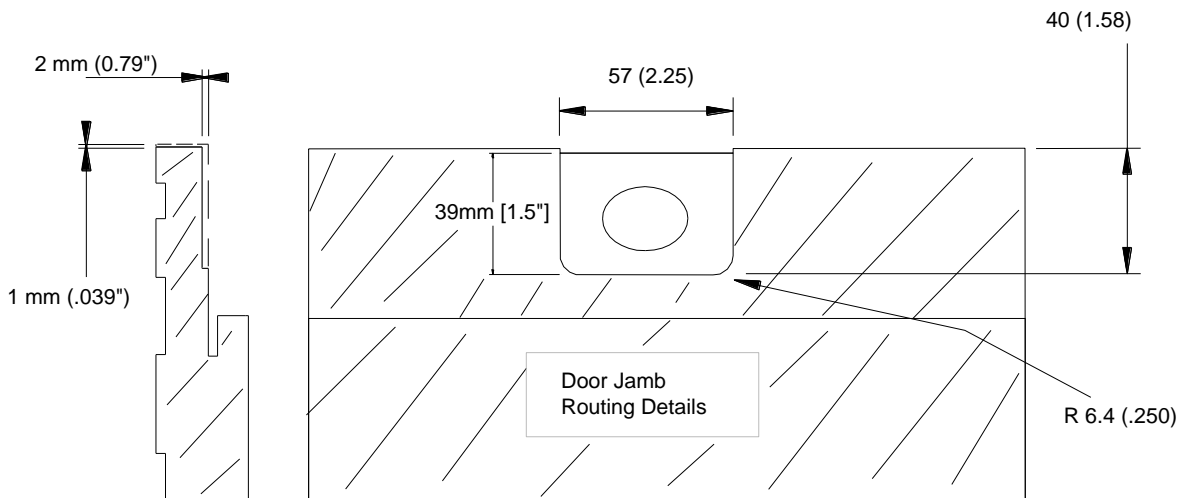



197-0700-2 Adjustable Tie Bar (SST Rollers)

MATERIALS AND FINISHING:

Strengthened steel tie bar with an ultra durable powder coat finish, protects against rust and UV rays. Available in 4 different types (see next page.)

ORDERING INFORMATION

1. Choose desired type and size (indicate by part number.) Tie Bars are unhandled, useable as either left or right.
2. Specify quantity desired. Minimum order 1 box and multiples thereof.
Packaging: 50 Tie Bars / box
Weight: see specification sheets for weight of box

SELECT ADDITIONAL COMPONENTS.

Recommended:

Tie Bar Guide – refer to Tie Bar Accessories section

Multi Lock Keeper – refer to Keeper section

LIFETIME WARRANTY

All Acme Window Hardware Ltd. Components are provided with a lifetime warranty, please see Warranty section for full details

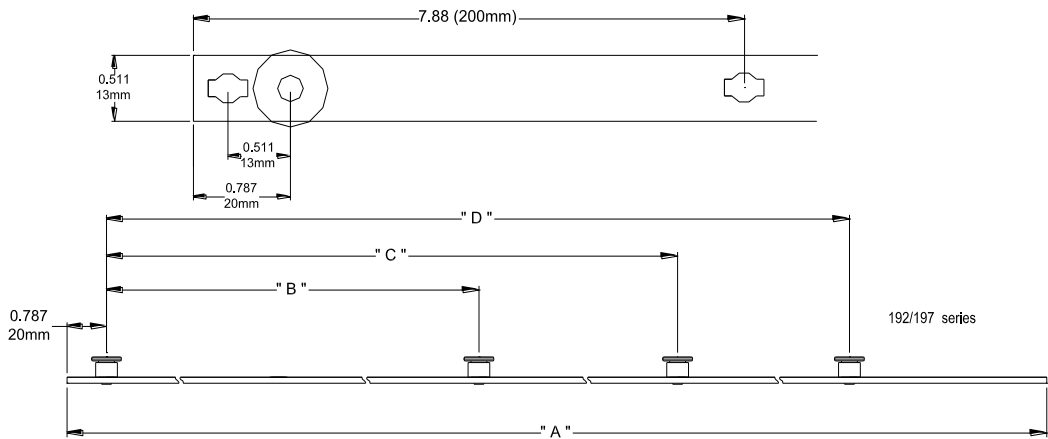

192/197		Rollers	A	B	C	D
192-0510	197-0510	1	160mm [6.3"]	N/A	N/A	N/A
192-0550	197-0550	1	200mm [7.9"]	N/A	N/A	N/A
192-0590	197-0590	1	240mm [9.4"]	N/A	N/A	N/A
192-0700	197-0700	2	350mm [14.3"]	230mm [9.1"]	N/A	N/A
192-0800	197-0800	2	450mm [17.7"]	330mm [13"]	N/A	N/A
192-0900	197-0900	2	550mm [21.7"]	430mm [17"]	N/A	N/A
192-1000	197-1000	2	650mm [25.6"]	530mm [20.9"]	N/A	N/A
192-1100R2	197-1100	3	750mm [29.5"]	355mm [14"]	630mm [24.8"]	N/A
192-1200	197-1200	3	850mm [33.5"]	405mm [16"]	730mm [29"]	N/A
192-1325	197-1325	3	975mm [39.8"]	467.5mm [18.4"]	855mm [33.7"]	N/A
192-1350	197-1350	3	1000mm [39.4"]	480mm [18.9"]	880mm [34.6"]	N/A
192-1500	197-1500	3	1150mm [45.3"]	555mm [21.9"]	1030mm [40.6"]	N/A
192-1625	197-1625	3	1275mm [50.2"]	617.5mm [24.3"]	1155mm [45.5"]	N/A
192-1650	197-1650	3	1300mm [51.2"]	630mm [24.8"]	1180mm [46.5"]	N/A
192-1800	197-1800	3	1450mm [57.1"]	705mm [27.8"]	1330mm [52.4"]	N/A
192-1925	197-1925	4	1575mm [62"]	530mm [20.9"]	1005mm [39.6"]	1455mm [57.3"]
192-1950	197-1950	4	1600mm [63"]	530mm [20.9"]	1005mm [39.6"]	1480mm [58.3"]
192-2100	197-2100	4	1750mm [68.9"]	545mm [21.5"]	1090mm [42.9"]	1630mm [64.2"]



198-0900 Adjustable Tie Bar SST Rollers (Come/w Lever Pin)

MATERIALS AND FINISHING:

Strengthened steel tie bar with an ultra durable powder coat finish, protects against rust and UV rays. Available in 4 different types (see next page.)

ORDERING INFORMATION

1. Choose desired type and size (indicate by part number.) Tie Bars are unhande d, useable as either left or right.
2. Specify quantity desired. Minimum order 1 box and multiples thereof.

Packaging: 50 Tie Bars / box

Weight: see specification sheets for weight of box

SELECT ADDITIONAL COMPONENTS.

Recommended:

Tie Bar Guide – refer to Tie Bar Accessories section

Multi Lock Keeper – refer to Keeper section

LIFETIME WARRANTY

All Acme Window Hardware Ltd. Components are provided with a lifetime warranty, please see Warranty section for full details

Tie Bar 198 Series

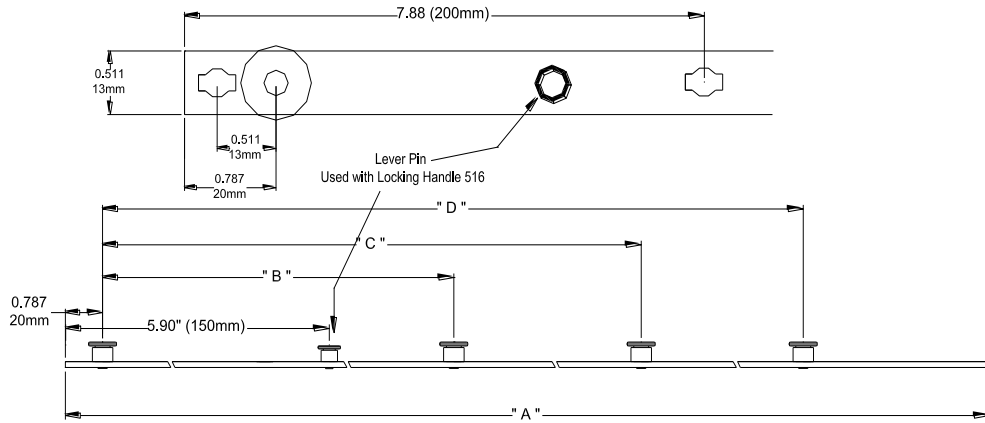

198 Series	Rollers	A	B	C	D
198-0510	1	160mm [6.3"]	N/A	N/A	N/A
198-0550	1	200mm [7.9"]	N/A	N/A	N/A
198-0590	1	240mm [9.4"]	N/A	N/A	N/A
198-0700	2	350mm [14.3"]	230mm [9.1"]	N/A	N/A
198-0800	2	450mm [17.7"]	330mm [13"]	N/A	N/A
198-0900	2	550mm [21.7"]	430mm [17"]	N/A	N/A
198-1000	2	650mm [25.6"]	530mm [20.9"]	N/A	N/A
198-1100	3	750mm [29.5"]	355mm [14"]	630mm [24.8"]	N/A
198-1200	3	850mm [33.5"]	405mm [16"]	730mm [29"]	N/A
198-1325	3	975mm [39.8"]	467.5mm [18.4"]	855mm [33.7"]	N/A
198-1350	3	1000mm [39.4"]	480mm [18.9"]	880mm [34.6"]	N/A
198-1500	3	1150mm [45.3"]	555mm [21.9"]	1030mm [40.6"]	N/A
198-1625	3	1275mm [50.2"]	617.5mm [24.3"]	1155mm [45.5"]	N/A
198-1650	3	1300mm [51.2"]	630mm [24.8"]	1180mm [46.5"]	N/A
198-1800	3	1450mm [57.1"]	705mm [27.8"]	1330mm [52.4"]	N/A
198-1925	4	1575mm [62"]	530mm [20.9"]	1005mm [39.6"]	1455mm [57.3"]
198-1950	4	1600mm [63"]	530mm [20.9"]	1005mm [39.6"]	1480mm [58.3"]
198-2100	4	1750mm [68.9"]	545mm [21.5"]	1090mm [42.9"]	1630mm [64.2"]

Note: 200 Series = Steel Powder Coat; 7200 Series = Stainless Steel

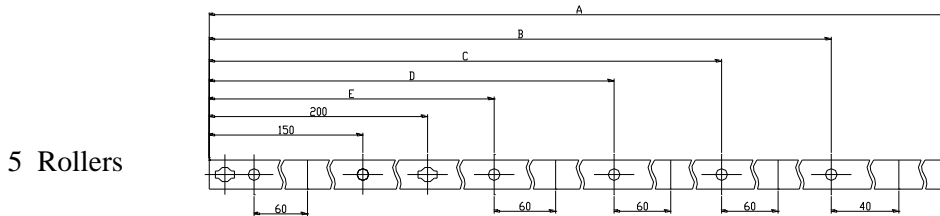
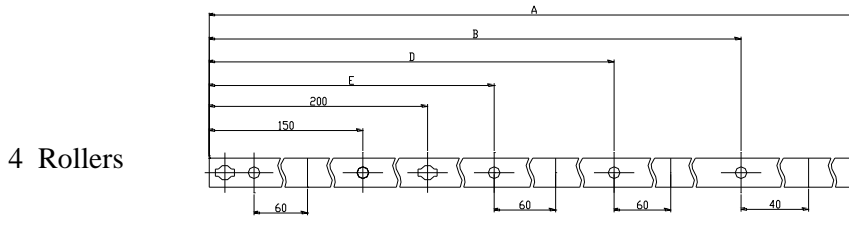
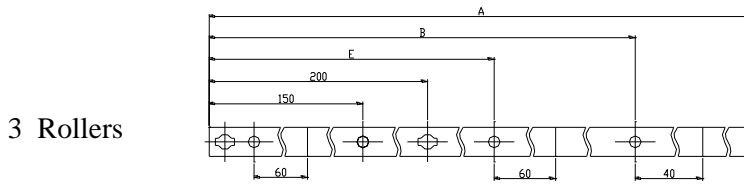
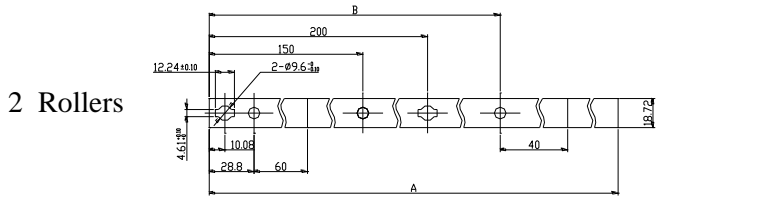

OSM Window Height	Part Number	Rollers	"A"	"B"	"C"	"D"	"E"
400-499mm	7200-0400	2	230mm	N/A	N/A	N/A	N/A
500-599mm	7200-0500	2	330mm	250mm	N/A	N/A	N/A
600-699mm	7200-0600	2	430mm	350mm	N/A	N/A	N/A
700-799mm	7200-0700	2	530mm	450mm	N/A	N/A	N/A
800-899mm	7200-0800	2	630mm	550mm	N/A	N/A	N/A
900-999mm	7200-0900	3	730mm	650mm	N/A	N/A	365mm
1000-1099mm	7200-1000	3	830mm	750mm	N/A	N/A	415mm
1100-1199mm	7200-1100	3	930mm	850mm	N/A	N/A	465mm
1200-1299mm	7200-1200	4	1030mm	950mm	N/A	686.7mm	343.3mm
1300-1399mm	7200-1300	4	1130mm	1050mm	N/A	753.3mm	376.7mm
1400-1499mm	7200-1400	4	1230mm	1150mm	N/A	820mm	410mm
1500-1599mm	7200-1500	4	1330mm	1250mm	N/A	886.7mm	443.3mm
1600-1699mm	7200-1600	4	1430mm	1350mm	N/A	953.3mm	476.7mm
1700-1799mm	7200-1700	5	1530mm	1450mm	1092.5mm	735mm	377.5mm
1800-1899mm	7200-1800	5	1630mm	1550mm	1167.5mm	785mm	402.5mm
1900-1999mm	7200-1900	5	1730mm	1650mm	1242.5mm	835mm	427.5mm
2000-2099mm	7200-2000	5	1830mm	1750mm	1317.5mm	885mm	452.5mm



19070 – Tie Bar Connector



2020 – Tie Bar Guide

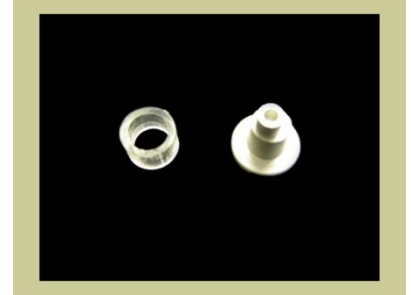

9210 – Adjustable Tie Bar Roller and Strike

MATERIALS AND FINISHING:

Tie Bar Connectors constructed of strengthened steel with an ultra durable powder coat finish, protects against rust and UV rays. Tie Bar Strikes made from aluminums with mill finish. Tie Bar Rollers and Tie Bar Guides constructed of high strength, high density nylon.

- Tie Bar Guide:
Packaging: 2500 (5x500) Weight: 11Kg / Box
- Roller & Striker:
9010 & 9210
Packaging: 1,000 (5x200)
Weight: 5Kg / Box

ORDERING INFORMATION

- Choose desired components (indicate by part number)
- Tie Bar Connector:
Specify quantity desired.
Minimum order 1 box and multiples thereof.
Packaging: 1000 (5x200)
Weight: 16Kg /Box

LIFETIME WARRANTY

All Acme Window Hardware Ltd. Components are provided with a lifetime warranty, please see Warranty section for full details

Tie Bar Connector - For Locking Handle #504 Used Only

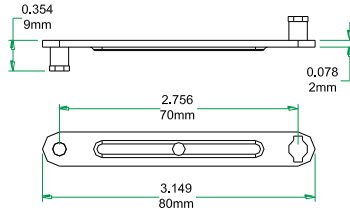

Model	Description	Material	Orientation
19070	Long , 2 Studs Opposite	Steel	Non-handed

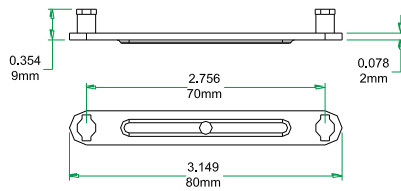

Model	Description	Material	Orientation
19071	Long , 2 Studs Side	Steel	Non-handed

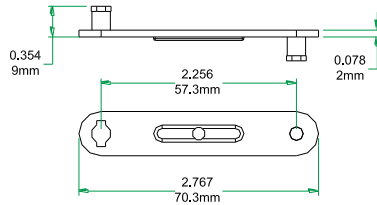

Model	Description	Material	Orientation
190701	Short , 2 Studs Opposite	Steel	Non-handed

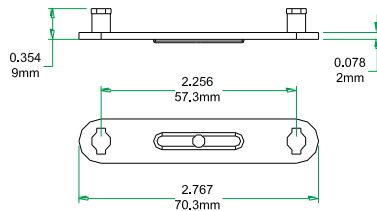

Model	Description	Material	Orientation
190702	Short , 2 Studs Side	Steel	Non-handed

Tie Bar Guides

Model	" A "	" B "	Orientation
2020	1.063"	0.106"	Non-handed

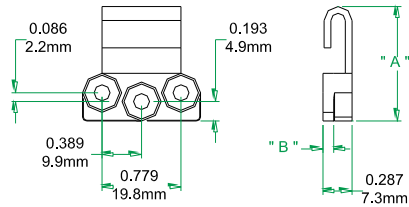

Model	" A "	" B "	Orientation
2022	1.059"	0.122"	Non-handed

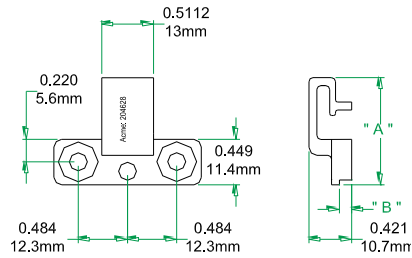

Model	" A "	" B "	Orientation
2024	1.309"	0.354"	Non-handed

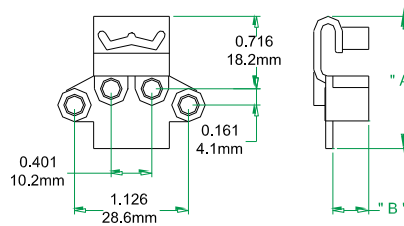

Model	" A "	" B "	Orientation
2025	1.456"	0.122"	Non-handed

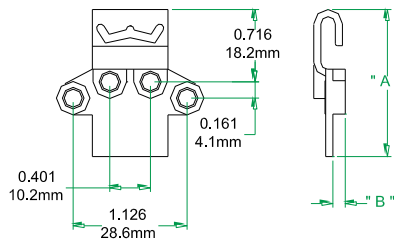

Tie Bar Guides

Model	" A "	" B "	Orientation
2026	1.043"	0.334"	Non-handed

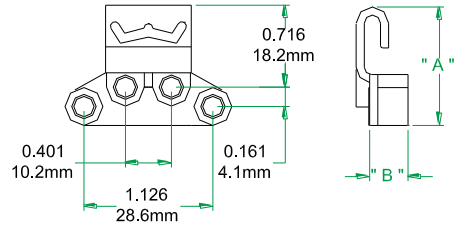

Model	" A "	" B "	Orientation
20320	1.259"	0.228"	Non-handed

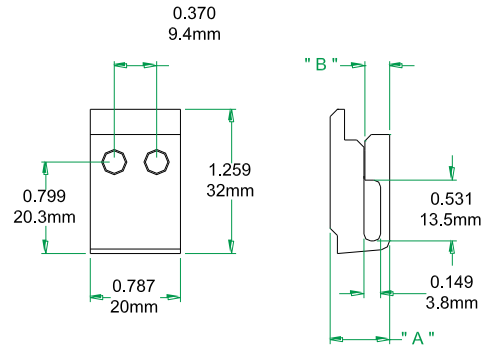

Model	" A "	" B "	Orientation
20321	0.519"	0.137"	Non-handed

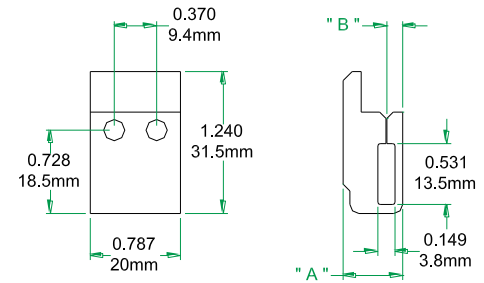

Model	" A "	" B "	Orientation
2076	1.588"	0.224"	Non-handed

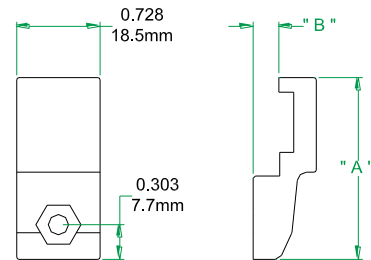

Decore Scissor Awning Operator 15"



130-635-SC15 Decore Scissor Awning Operator + Track & Sliding Devices

MATERIALS AND FINISHING:

Die cast zinc base, and strengthened steel guide arms all with an ultra durable powder coat finish, protects against rust and UV rays.

ORDERING INFORMATION:

- A. Decore Scissor Awning Operator
 - Specify orientation, indicated by:
 - None Handed

- B. **Cover color indicate by part number:**
 - 130066 = Ivory White
 - 132066 = White
 - 136066 = Beige

- C. **SPECIFY QUANTITY DESIRED.**
Minimum order 1 box and multiples thereof.

Packaging: 20 operators / box
Weight: see specification sheets for weight of box

SELECT ADDITIONAL COMPONENTS.

Recommended:

- Awning Track # 190030 or 70030-Stainless Steel
- Sliding Device # 20070 (2 Req.)
- Back Plate # 19026
- **Decore Crank & Cover:130066 - LH**

For details: please refer to NEXT PAGE

Frame cut out see drawing next page

LIFETIME WARRANTY

All Acme Window Hardware Ltd. Components are provided with a lifetime warranty, please see Warranty section for full details

Profile Cut-Out Details

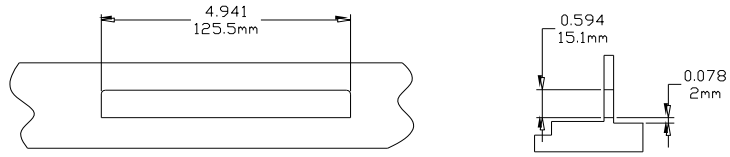

Decore Scissor Awning Operator

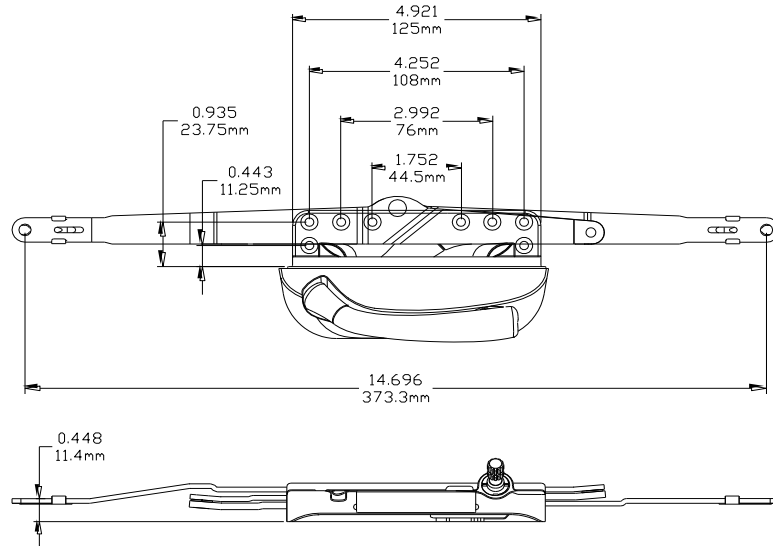

Track 190030 / 70030

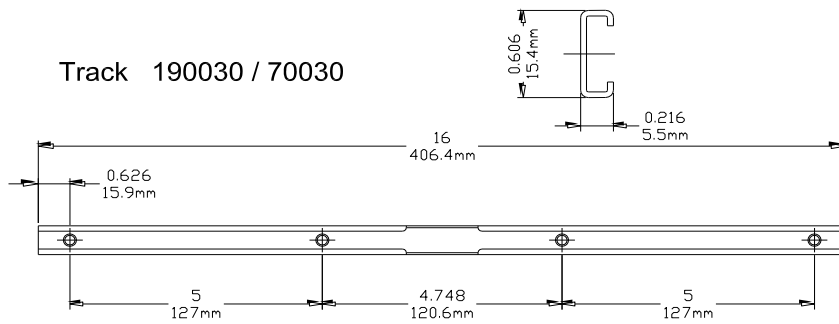

Slider Piece 20070

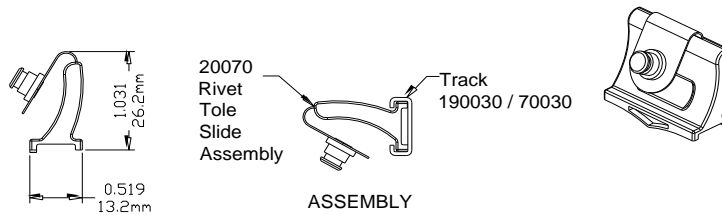

Decore Narrow Awning Operator 12"



130-635-XC12 Decore Awning Operator 12"+ Central Hook # 19080

MATERIALS AND FINISHING:

Die cast zinc base, and strengthened steel guide arms all with an ultra durable powder coat finish, protects against rust and UV rays.

SELECT ADDITIONAL COMPONENTS.

Recommended:

- Central Hook # 19081 or 19080 (Adjustable)
- Back Plate # 19026
- **Decore Crank & Cover:130066 L/H**

ORDERING INFORMATION:

- A. Decore Scissor Awning Operator
 - Specify orientation, indicated by:
 - None Handed
- B. **Cover color indicated by part number:**
 - 130066 = Ivory White
 - 132066 = White
 - 136066 = Beige

For more details: please refer to NEXT PAGE

Frame cut out same as Scissor Awning Operator

C. **SPECIFY QUANTITY DESIRED.**

Minimum order 1 box and multiples thereof.

Packaging: 20 operators / box

Weight: see specification sheets for weight of box

LIFETIME WARRANTY

All Acme Window Hardware Ltd. Components are provided with a lifetime warranty, please see Warranty section for full details

Decore Awning Operator

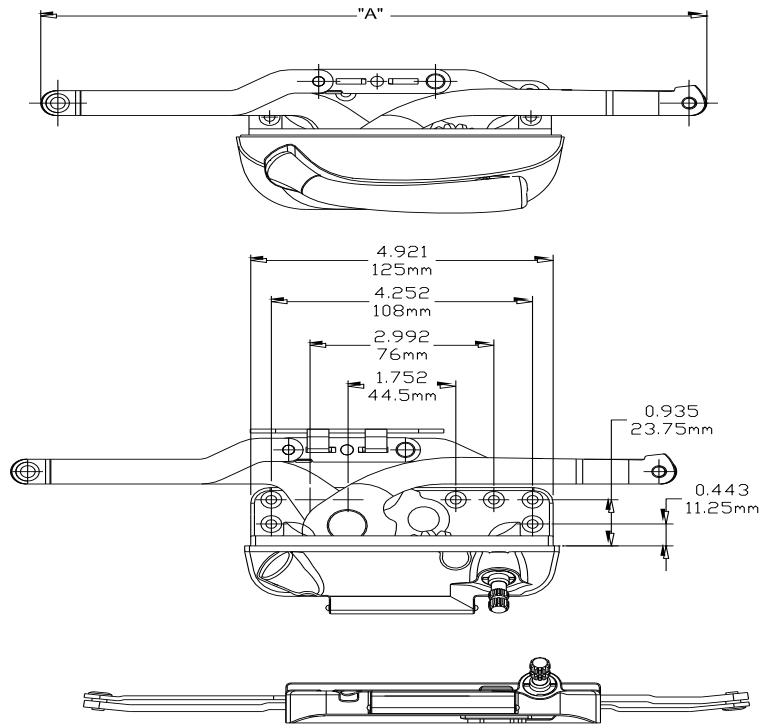

Product Name	Part Number	"A"
12" Decore Awning Operator	130-635-XC12	12 "

Sash Hook 19080

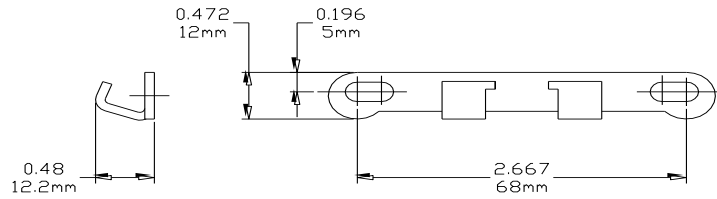

Sash Hook 19081

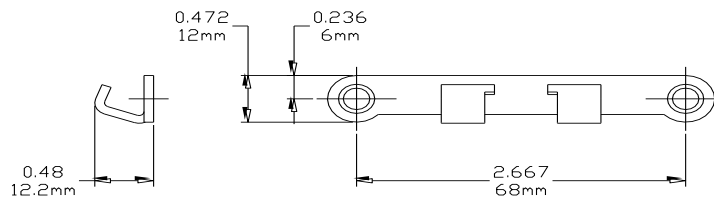

Decore Dual Arm Operators



130-635-R Decore Dual Arm Operator (R/H Shown) + Track & Stud Bracket (shown)

130-635-S-R Decore Short Arm Dual Arm Operators – Please Refer to next page for details

MATERIALS AND FINISHING:

Die cast zinc base, and strengthened steel guide arms all with an ultra durable powder coat finish, protects against rust and UV rays.

ORDERING INFORMATION:

- A. Decore Dual Arm Operators
 - Specify orientation, indicated by:
 - R for right hand
 - L for left hand

- B. **Cover color indicated by part number:**
 - 130066 = Ivory White
 - 132066 = White
 - 136066 = Beige

- C. **SPECIFY QUANTITY DESIRED.**
Minimum order 1 box and multiples thereof.

Packaging: 20 operators / box
Weight: see specification sheets for weight of box

SELECT ADDITIONAL COMPONENTS.

Recommended:

- Variable Stud Brackets: 19039; 19040 or 19041; 19042 or 190440; 190442
- Mounting Tracks (Variable in size and materials): 19051; 19052 or 70051; 70052
- Back Plate # 19026
- **Decore Crank & Cover: 130066 - LH / 130067 - RH**

For details: please refer to FOLLOWING PAGES

WINDOWS WIDTH RECOMMENDED:

- Minimum: 21" (508mm)
- Maximum: 35" (890mm)

Frame cut out same as Scissor Awning Operator

LIFETIME WARRANTY

All Acme Window Hardware Ltd. Components are provided with a lifetime warranty, please see Warranty section for full details

Decore Dual Arm Operator (Sill Mount)

132635 - L (Left Hand Shown)

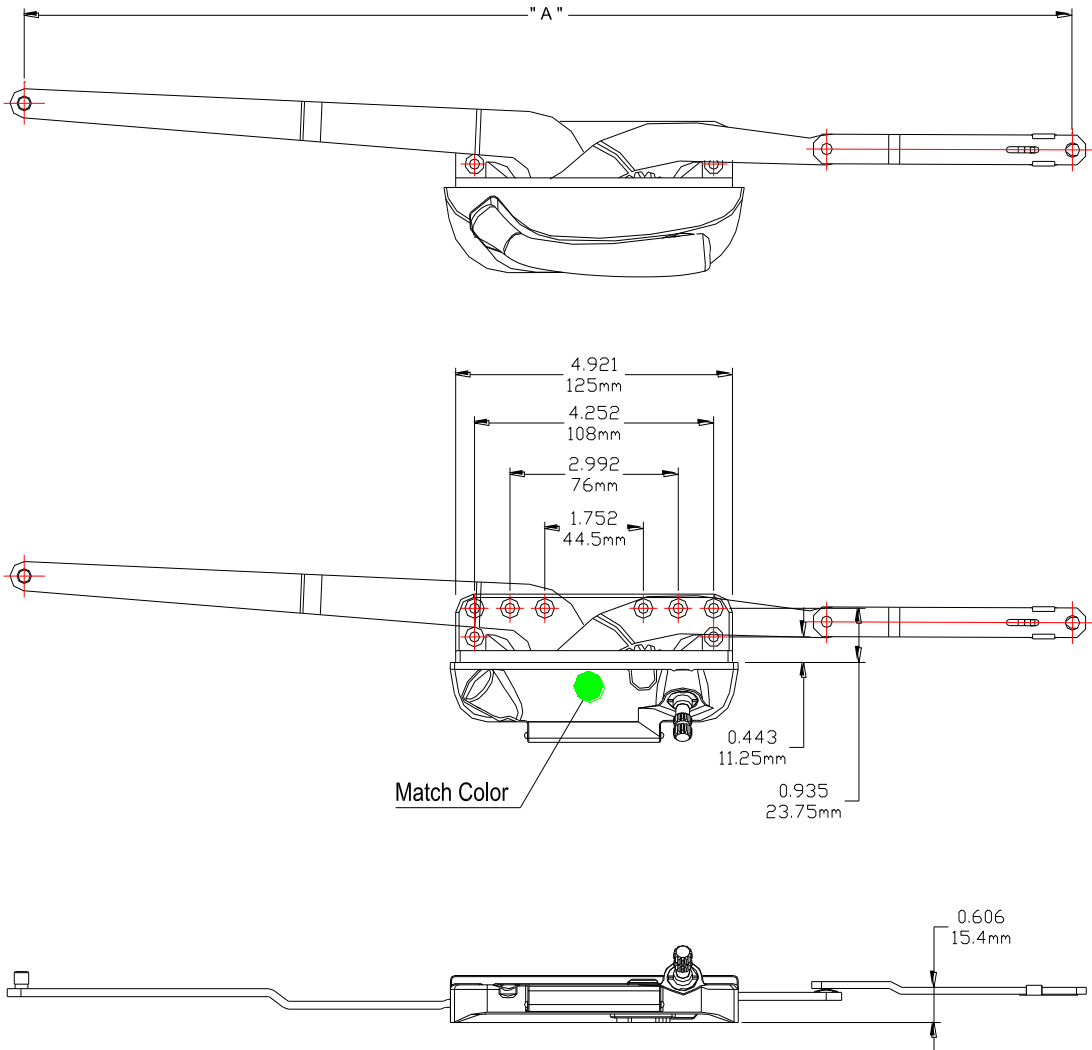

Product Name	Part Number	" A "	Window Width	Match Color
Decore Dual Arm Operator , LH	130-635 - L	18.834"	Min. 21" Max.36"	Green
Decore Dual Arm Operator , RH	130-635 - R	18.834"	Min. 21" Max.36"	Red
Decore Short Arm Dual Arm Operator , LH	130-635S - L	15.945"	Min. 18" Max.24"	Green
Decore Short Arm Dual Arm Operator , RH	130-635S - R	15.945"	Min. 18" Max.24"	Red

Track

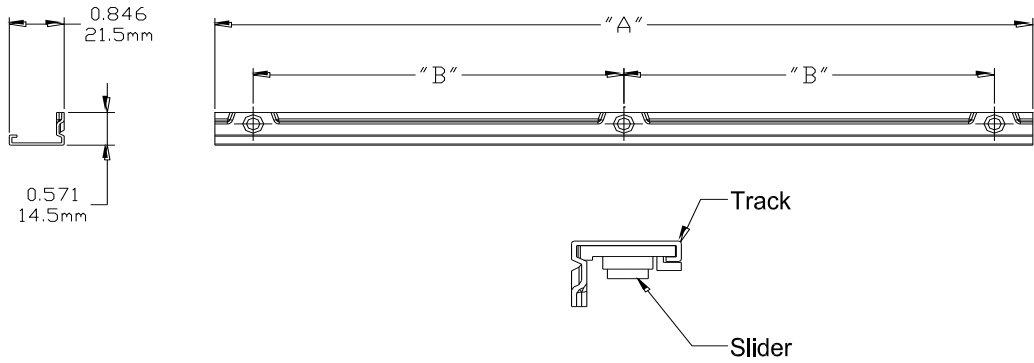

Dual Arm Operator Track 3 Holes			
Part Number	" A "	" B "	Material
70051	14.449"	6.496"	SST
190051	14.449"	6.496"	Steel
70052	12.598"	5.708"	SST
190052	12.598"	5.708"	Steel

Stud Bracket (Right Hand Shown)

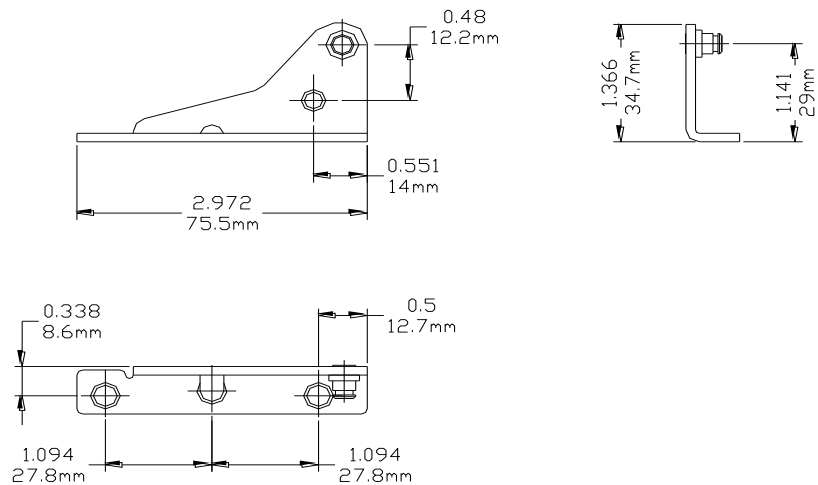

Part Number	Material	Hand
70455	SST	RH
70456	SST	LH
190455	Steel	RH
190456	Steel	LH

Decore Dual Arm Operators

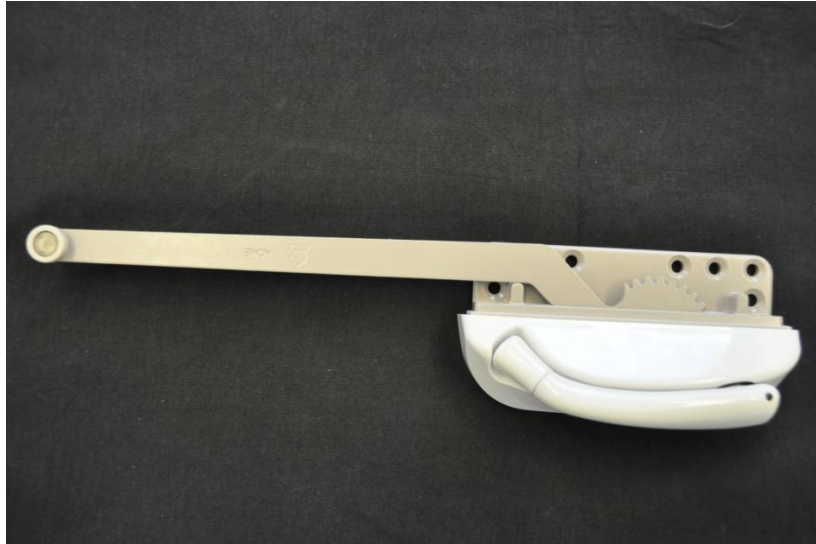

130-635-LZ Decore SINGLE Arm Operator (L/H Shown)

MATERIALS AND FINISHING:

Die cast zinc base, and strengthened steel guide arms all with an ultra durable powder coat finish, protects against rust and UV rays.

ORDERING INFORMATION:

- A. Decore Single Arm Operators
 - Specify orientation, indicated by:
 - LZ for left hand
 - RZ for right hand

- B. Cover color indicated by part number:
 - 130066 = Ivory White
 - 132066 = White
 - 136066 = Beige

SPECIFY QUANTITY DESIRED.

Minimum order 1 box and multiples thereof.

Packaging: 20 operators / box

Weight: see specification sheets for weight of box

SELECT ADDITIONAL COMPONENTS.

Recommended:

- Mounting Track 2 Holes # 70055/70056 (Stainless Steel)
- Mounting Track 4 Holes # 190040 (Steel Powder Coat)
- Back Plate # 19026
- Decore Crank & Cover: 130066 - LH / 130067 - RH

For more details: please refer to: FOLLWOING PAGES

WINDOWS WIDTH RECOMMENDED:

- Please refer to next page

Frame cut out same as Scissor Awning Operator

LIFETIME WARRANTY

All Acme Window Hardware Ltd. Components are provided with a lifetime warranty, please see Warranty section for full details

Decore Single Arm Operator (Sill Mount)

132635 - LZ (Left Hand Shown)

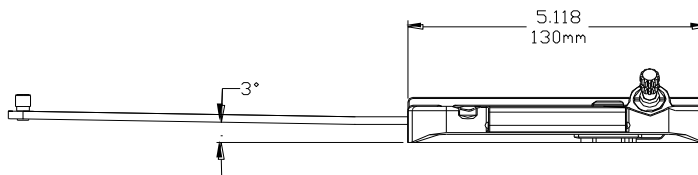
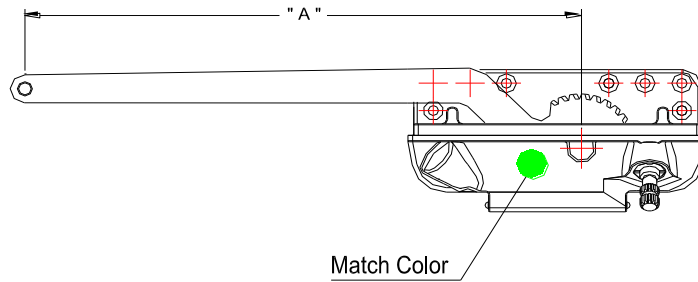
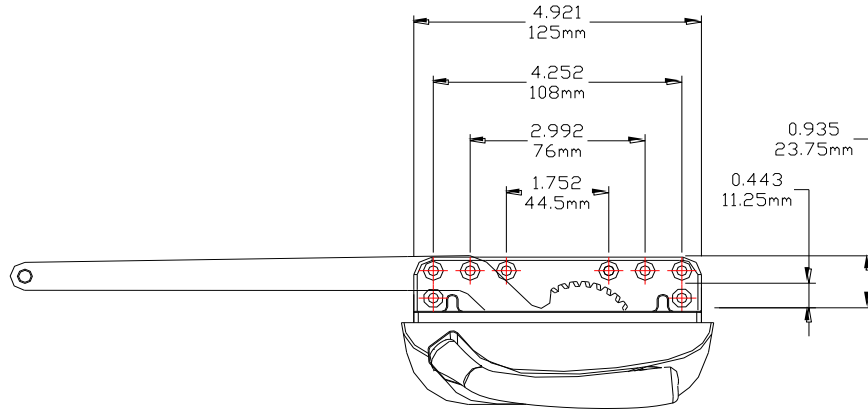

Product Name	Part Number	A (Arm Length)	Match Color
Decore Single Arm Operator 7.5" , LH	130-635-LZ75	7.5"	Green
Decore Single Arm Operator 7.5" , RH	130-635-RZ75	7.5"	Red
Decore Single Arm Operator 9.5" , LH	130-635-LZ95	9.5"	Green
Decore Single Arm Operator 9.5" , RH	130-635-RZ95	9.5"	Red
Decore Single Arm Operator 13.5" , LH	130-635-LZ135	13.5"	Green
Decore Single Arm Operator 13.5" , RH	130-635-RZ135	13.5"	Red

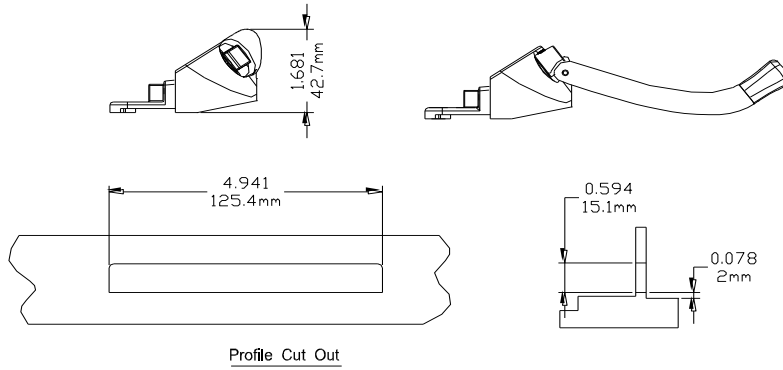

Cover and Crank Match Color

Part Number	Match Color
132066	Green
132067	Red

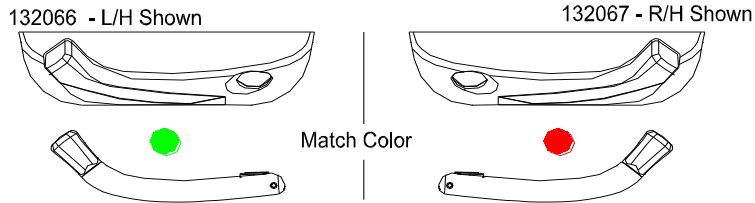

Track

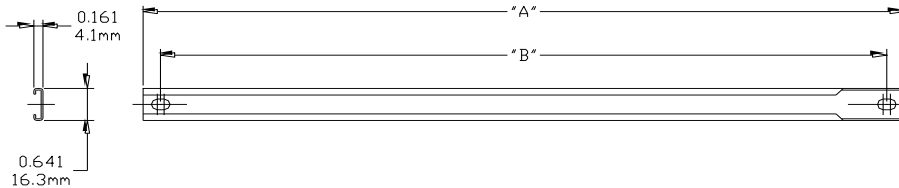

Single Arm Operator Track 2 Holes			
Part Number	" A "	" B "	Material
70055	13.75"	13.12"	SST
70056	17.795"	17.165"	SST

Single Arm Operator Mounting Track 4 Holes

Part Number	" A "	" B "	Material
190040	11.09"	N/A	Steel

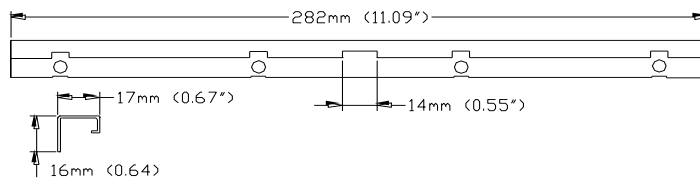



130-635-S-RQS Decore Dyad Operator 4.5" (RH – Shown)

Stud Bracket #19042 (RH Shown)

MATERIALS AND FINISHING:

Die cast zinc base, and strengthened steel guide arms all with an ultra durable powder coat finish, protects against rust and UV rays.

ORDERING INFORMATION:

- A. Decore Dyad Operators
 - Specify orientation, indicated by:
 - RQS for right hand
 - LQS for left hand

- B. Cover color indicated by part number:
 - 130066 = Ivory White
 - 132066 = White
 - 136066 = Beige

- C. SPECIFY QUANTITY DESIRED.
Minimum order 1 box and multiples thereof.

Packaging: 20 operators / box

Weight: see specification sheets for weight of box

SELECT ADDITIONAL COMPONENTS.

Recommended:

- Variable Stud Brackets Available: 19039; 19040 or 19041; 19042 or 190440; 190442
- Back Plate # 19026
- Decore Crank & Cover: 130066 - LH / 130067 - RH

For details: please refer to Operator Accessories section

WINDOWS WIDTH RECOMMENDED:

- Minimum: 16" (394mm)
- Maximum: 20" (508mm)

Frame cut out same as Scissor Awning Operator

LIFETIME WARRANTY

All Acme Window Hardware Ltd. Components are provided with a lifetime warranty, please see Warranty section for full details

Decore Dyad Operator (Sill Mount)

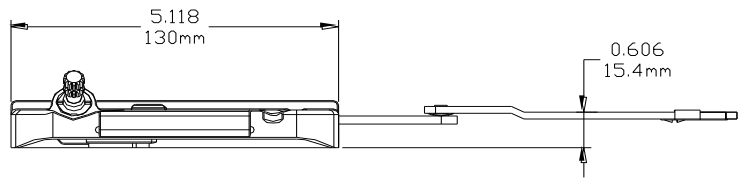
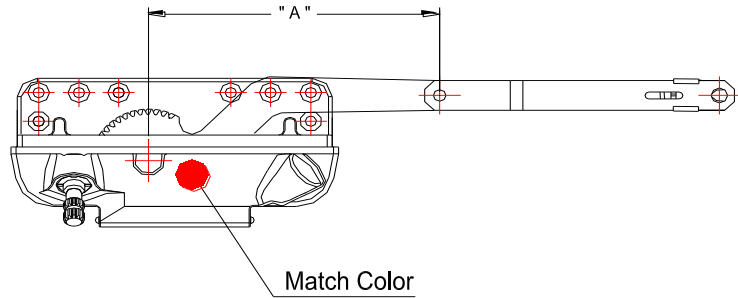
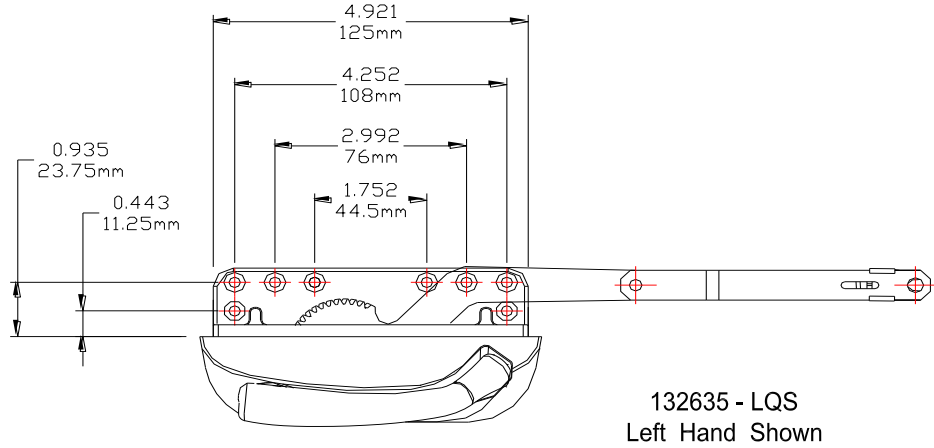

Product Name	Part Number	A (Arm Length)	Match Color
Decore Dyad Operator , 4.5" , LH	130-635S - LQS	4.5"	Red
Decore Dyad Operator , 4.5" , RH	130-635S - RQS	4.5"	Green
Decore Dyad Operator , 4.75" , LH	130-635 - LQS	4.75"	Red
Decore Dyad Operator , 4.75" , RH	130-635 - RQS	4.75"	Green

Decore Dyad Operator (Low Profile)

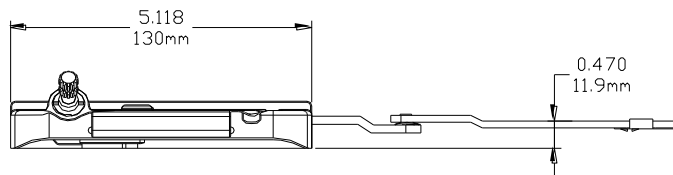
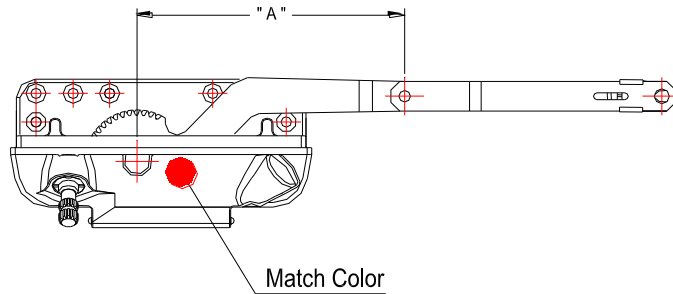
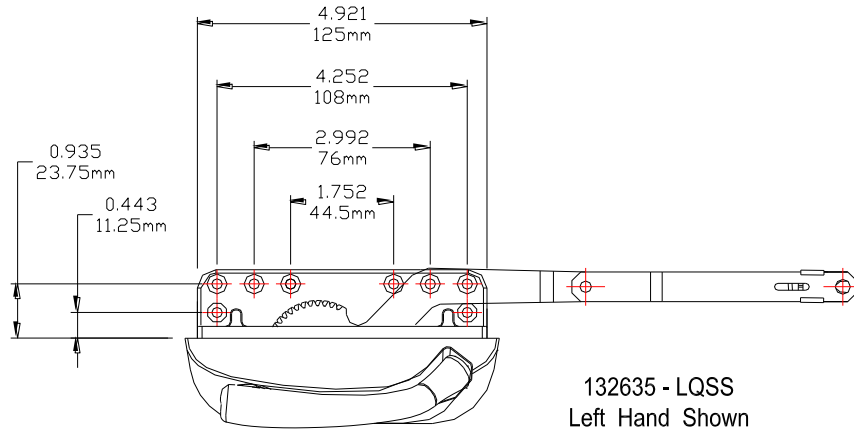

Product Name	Part Number	A (Arm Length)	Match Color
Decore Dyad Operator , 4.5" , LH	130-635S - LQSS	4.5"	Red
Decore Dyad Operator , 4.5" , RH	130-635S - RQSS	4.5"	Green
Decore Dyad Operator , 4.75" , LH	130-635 - LQSS	4.75"	Red
Decore Dyad Operator , 4.75" , RH	130-635 - RQSS	4.75"	Green

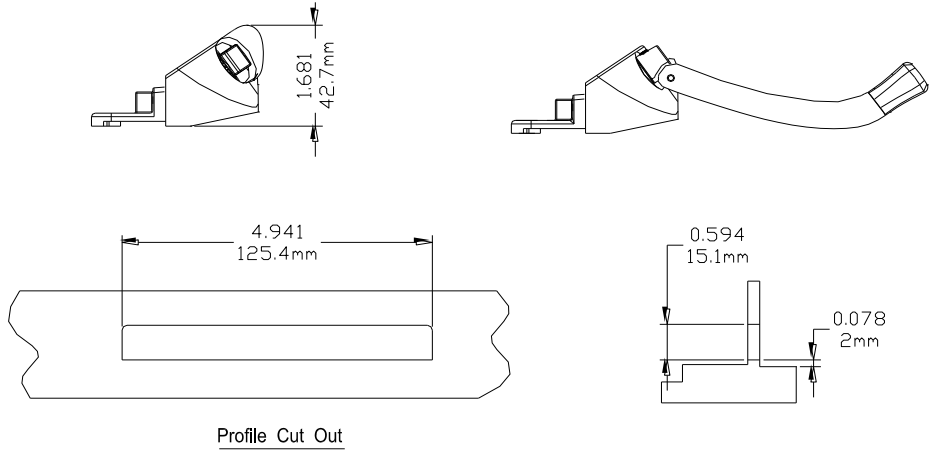

Cover and Crank Match Color

Part Number	Match Color
130066-Ivory White	Green
130067-Ivory White	Red

130066 Shown

130067 Shown

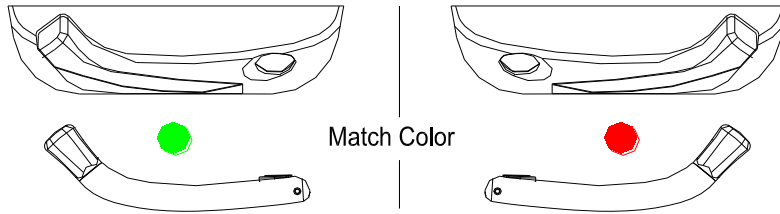

Back Plate 19026

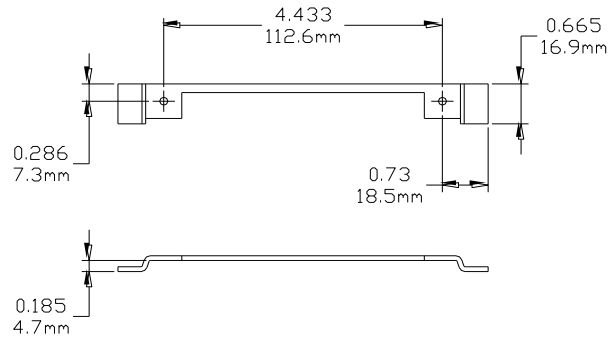

Stud Bracket (Right Hand Shown)

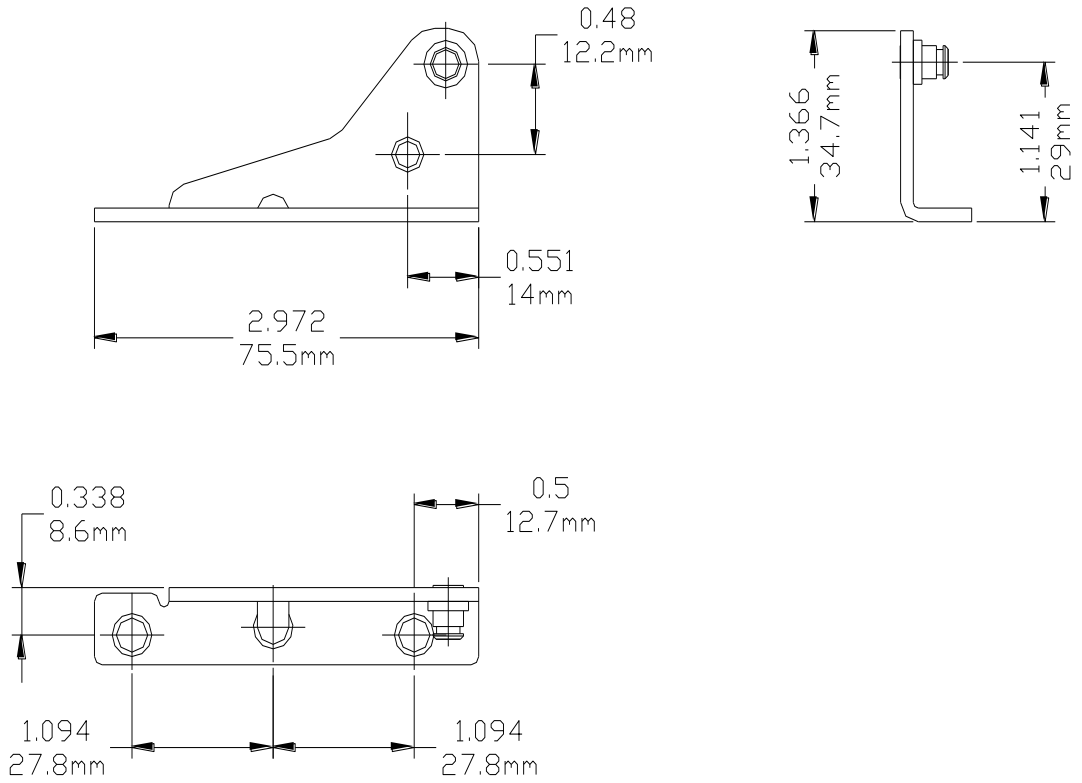

Part Number	Material	Hand
70455	SST	RH
70456	SST	LH
190455	Steel	RH
190456	Steel	LH

Decore Reverse Dyad Operator (Sill Mount)

130-635 - LQSW (Left Hand Shown)

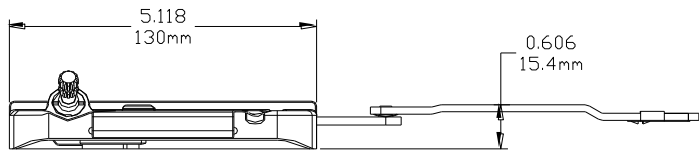
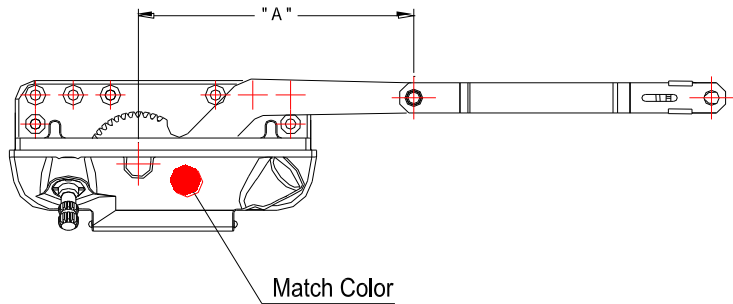
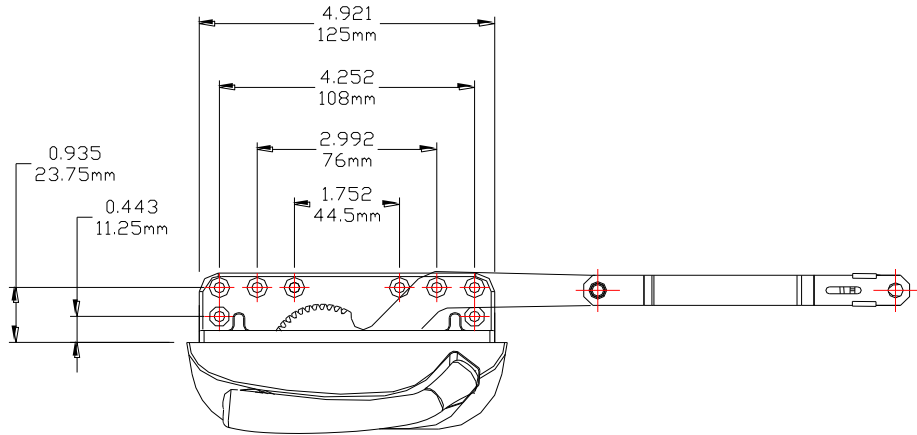

Product Name	Part Number	A (Arm Length)	Match Color
Decore Dyad Operator , 4.5" , LH	130-635S - LQSW	4.5"	Red
Decore Dyad Operator , 4.5" , RH	130-635S - RQSW	4.5"	Green
Decore Dyad Operator , 4.75" , LH	130-635 - LQSW	4.75"	Red
Decore Dyad Operator , 4.75" , RH	130-635 - RQSW	4.75"	Green

Decore Reverse Dyad Operator (Low Profile)

130-635 - LQSWS (Left Hand Shown)

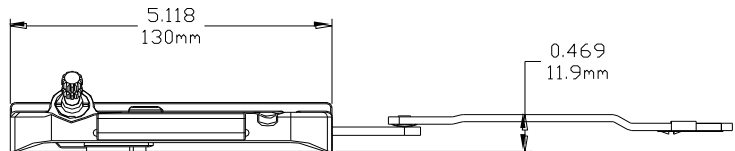
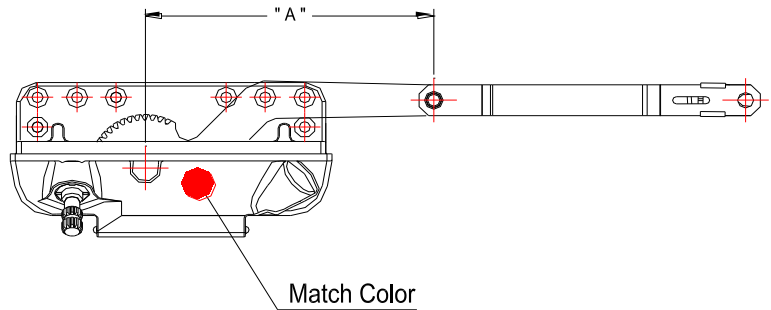
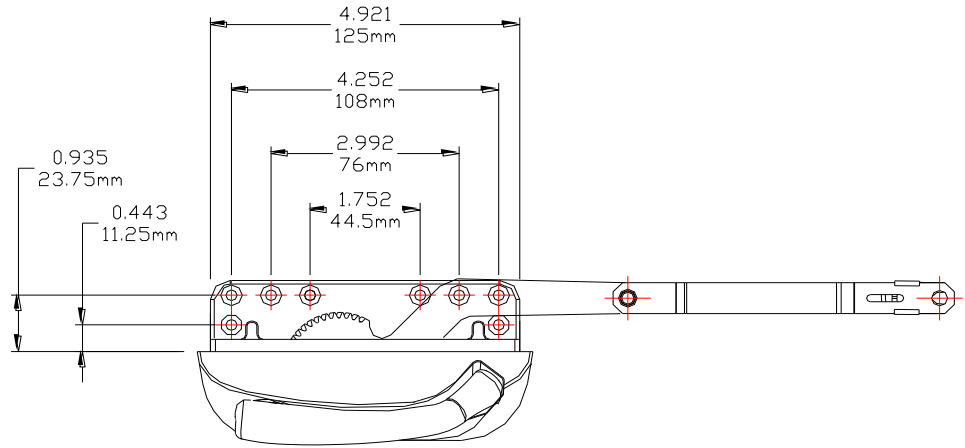

Product Name	Part Number	A (Arm Length)	Match Color
Decore Dyad Operator, 4.5", LH	130-635S - LQSWS	4.5"	Red
Decore Dyad Operator, 4.5", RH	130-635S - RQSWS	4.5"	Green
Decore Dyad Operator, 4.75", LH	130-635 - LQSWS	4.75"	Red
Decore Dyad Operator, 4.75", RH	130-635 - RQSWS	4.75"	Green

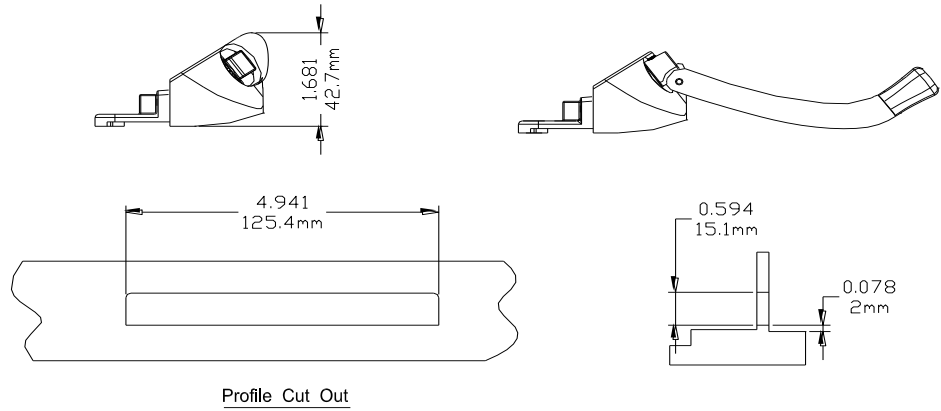

Cover and Crank Match Color

Part Number	Match Color
132066	Green
132067	Red

132066 Shown

132067 Shown

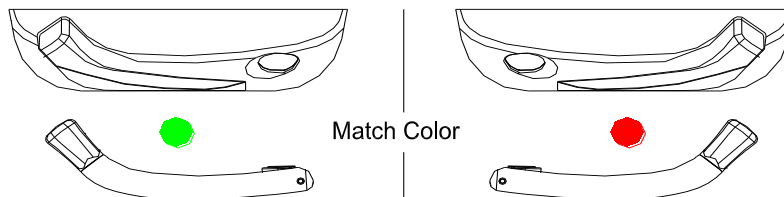

Stud Bracket 19048 (Non-Hand)

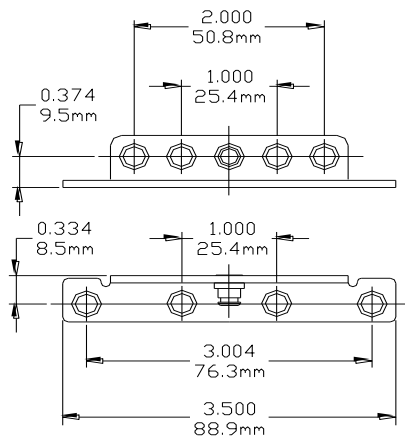

Decore Split Arm Operator

130-635 - LQS (Left Hand Shown)

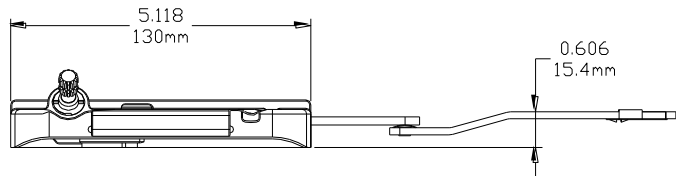
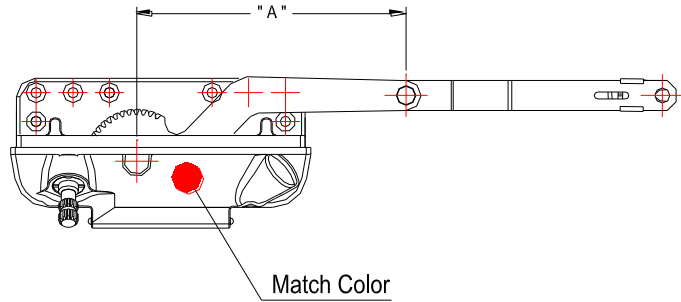
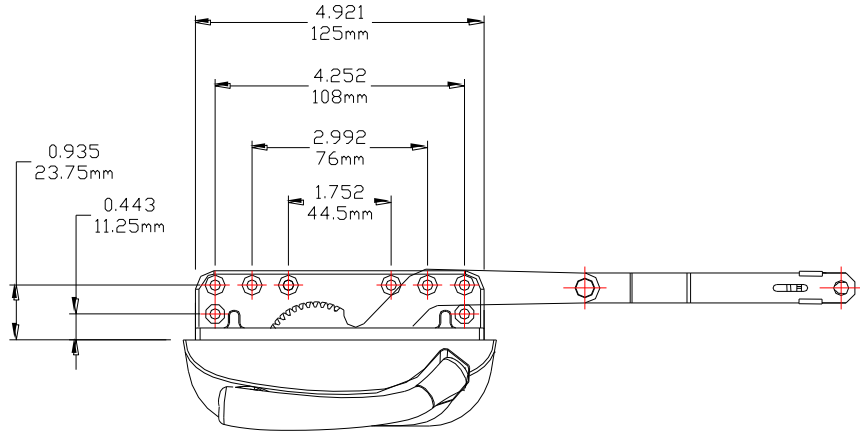

Product Name	Part Number	A (Arm Length)	Match Color
Decore Split Arm Operator, 4.5", LH	130-635S - LQX	4.5"	Red
Decore Split Arm Operator, 4.5", RH	130-635S - RQX	4.5"	Green
Decore Split Arm Operator, 4.75", LH	130-635 - LQX	4.75"	Red
Decore Split Arm Operator, 4.75", RH	130-635 - RQX	4.75"	Green

Stud Bracket (Right Hand Shown)

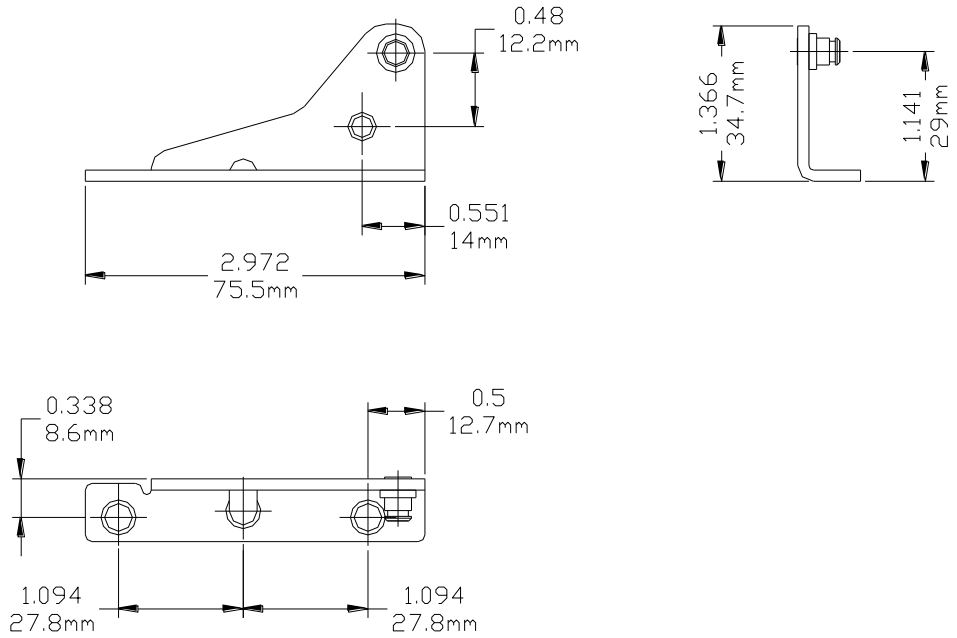

Part Number	Material	Hand
70455	SST	RH
70456	SST	LH
190455	Steel	RH
190456	Steel	LH

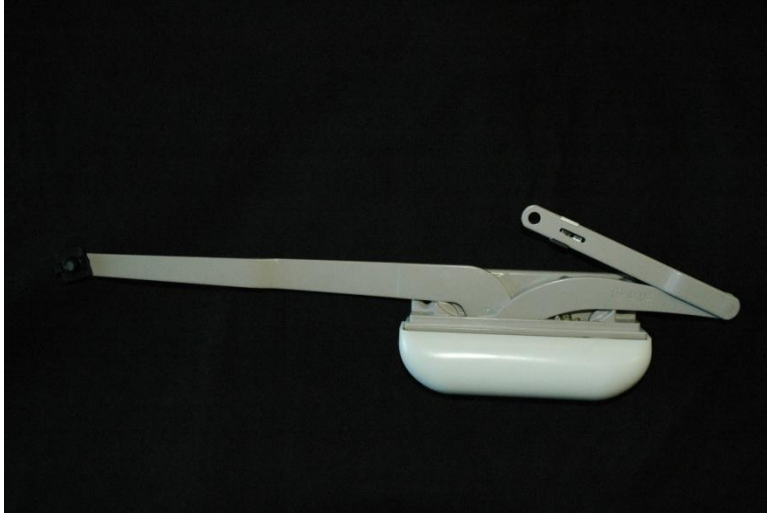

130-630-L Eclipse Dual Arm Operator (L/H) shown
Cover Closed

MATERIALS AND FINISHING:

Die cast zinc base, and strengthened steel guide arms all with an Ultra Durable powder coat finish, protects against rust and UV rays.

Note: Operators come/w with Crank Handle

ORDERING INFORMATION

Choose Operator type:

- 130-630-R : Right Hand
- 130-630-L: Left Hand
- 130-630S-R: Right Hand (Shorter Arm)
- 130-630S-L: Left Hand (Shorter Arm)

ADDITIONAL COMPONENTS

Recommended:

- Mounting Track: 70051 - 70052
- Stud Brackets:
Please refer to Operator Stud Brackets Section

Packaging:

- Qty/Box: 20/Pcs
- Weight: 25Kg/box

SELECT ADDITIONAL COMPONENTS.

Recommended:

- Operator's Cover: 100/Box (10x10)
- Cover color part Number:
 - # 26081 = Ivory White
 - # 26080 = White
 - # 16090 = Beige
 - Stud Brackets: 19039; 19040 or 19041; 19042 or 190440; 190442

For details: please refer to Operator Accessories section

WINDOWS WIDTH RECOMMENDED:

- Minimum: 21" (508mm)
- Maximum: 35" (890mm)

Frame cut out the same as Eclipse Dual Arm Operator

LIFETIME WARRANTY

All Acme Window Hardware Ltd. Components are provided with a lifetime warranty, please see Warranty section for full details

Eclipse Dual Arm Operators



130-630-L Eclipse Dual Arm Operator (L/H) + Track & Stud Bracket (shown)
Cover Open

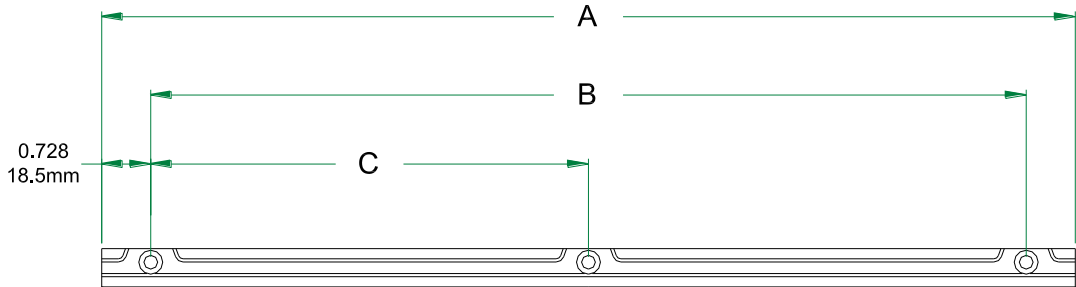

Dual Arm Track 3 Holes:

P/N	Material	"A"	"B"	"C"	Note:
70051	Stainless Steel	14.449"	12.992"	6.496"	Long
190051	Steel Powder Coat	14.449"	12.992"	6.496"	Long
70052	Stainless Steel	12.598"	11.416"	5.708"	Short
190052	Steel Powder Coat	12.598"	11.416"	5.708"	Short

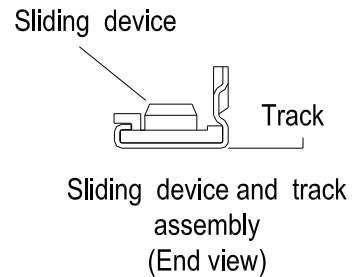
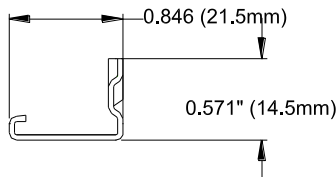

Eclipse Dual Arm Operators

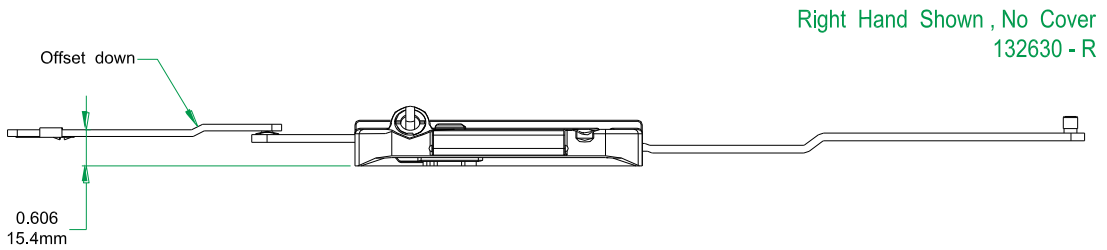
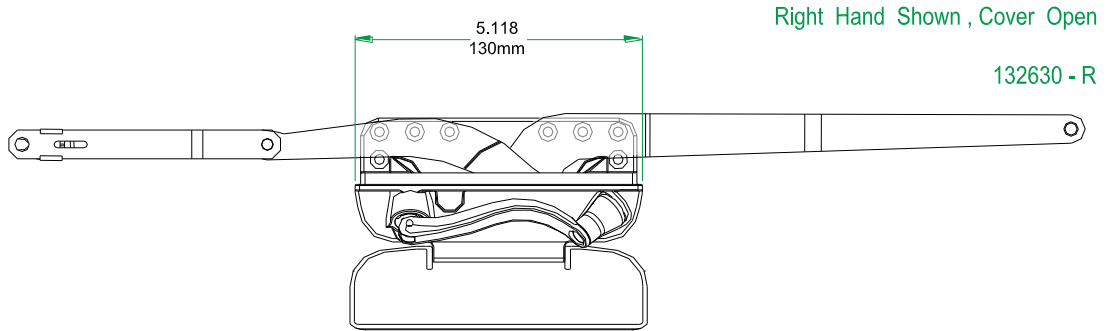
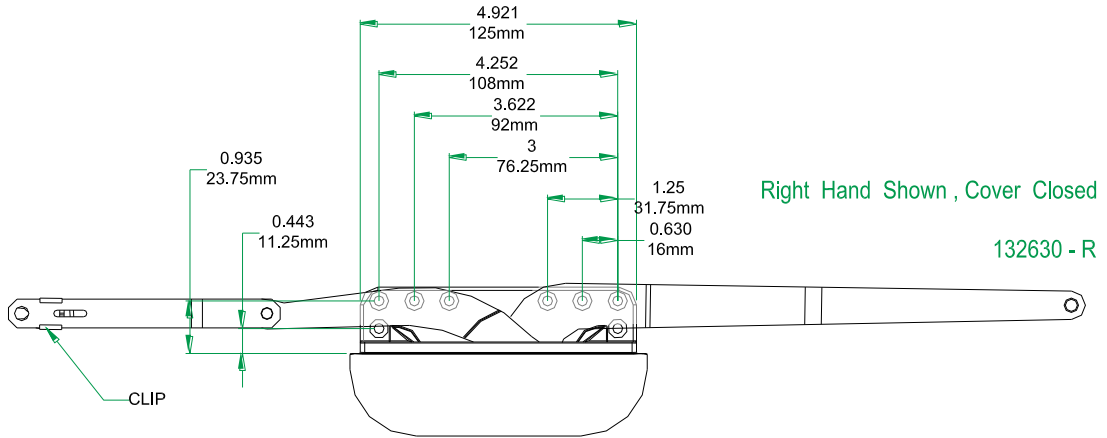

Eclipse Dyad Operators

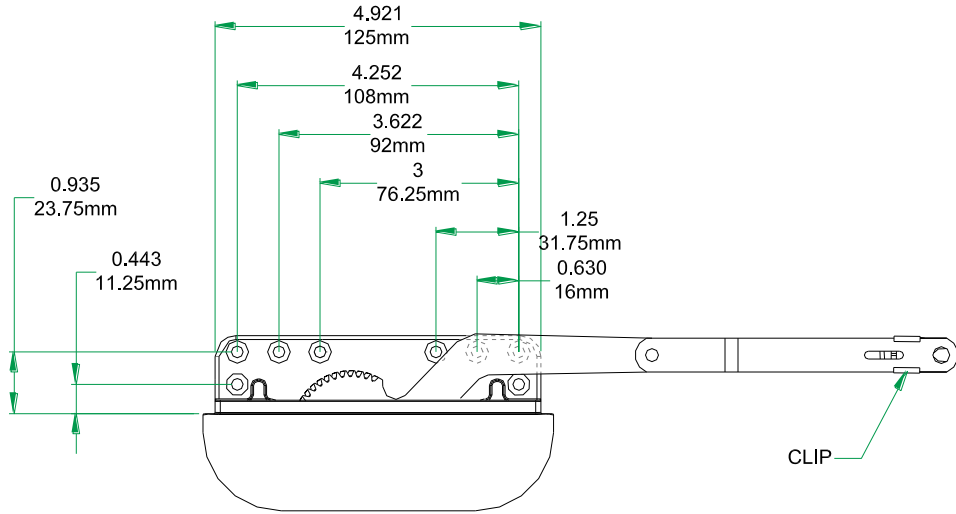

Left Hand Shown , Cover Closed

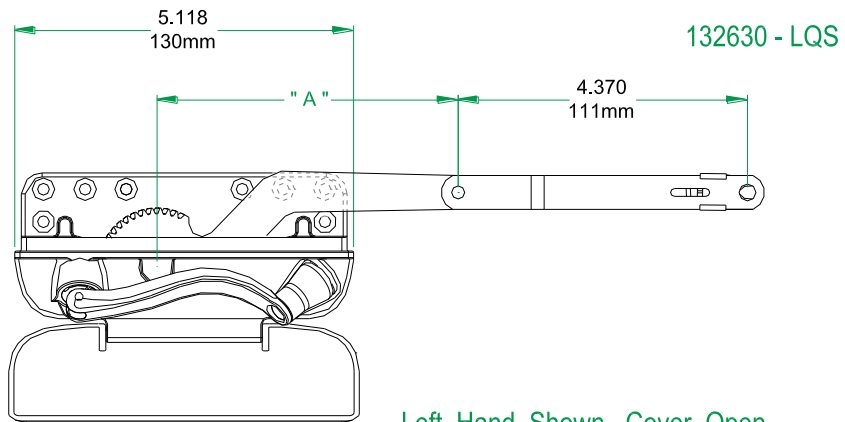

Left Hand Shown , Cover Open

132630 - LQS

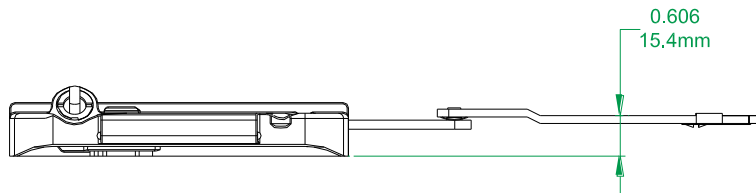

Left Hand Shown , No Cover

132630 - LQS



132630-S-RQS Eclipse Dyad Operator 4.5" (RH – Shown)
Cover Closed

MATERIALS AND FINISH:

Die cast zinc base, and strengthened steel guide arms all with an ultra durable powder coat finish, protects against rust and UV rays.

Note: Operators come/w with Crank Handle

ORDERING INFORMATION:

- A. Eclipse Dyad Operator
 - Specify orientation, indicated by:
 - RQS for right hand
 - LQS for left hand

- B. **Cover: Cover color indicated by part number:**
 - -130 for IvoryWhite
 - -132 for White
 - -136 for Beige

- C. **SPECIFY QUANTITY DESIRED.**
Minimum order 1 box and multiples thereof.

Packaging: 20 operators / box

Weight: see specification sheets for weight of box

SELECT ADDITIONAL COMPONENTS.

Recommended:

- **Operator's Cover: 100/Box (10x10)**
- Part Number:
- # 26081 = Ivory White
 - # 26080 = White
 - # 16090 = Beige
 - Stud Brackets: 19039; 19040 or 19041; 19042 or 190440; 190442

For details: please refer to Operator Accessories section

WINDOWS WIDTH RECOMMENDED:

- Minimum: 16" (394mm)
- Maximum: 20" (508mm)

Frame cut out the same as Eclipse Dual Arm Operator

LIFETIME WARRANTY

All Acme Window Hardware Ltd. Components are provided with a lifetime warranty, please see Warranty section for full details

Operator Stud Brackets (LH-Shown)

P/N	Material	Orientation
7041	SST	LH
7042	SST	RH
19041	STEEL	LH
19042	STEEL	RH

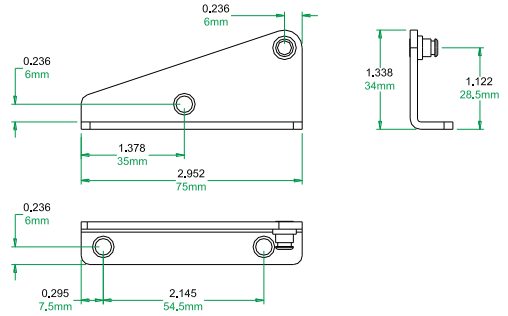

P/N	Material	Orientation
70440	SST	LH
70441	SST	RH
190440	STEEL	LH
190442	STEEL	RH

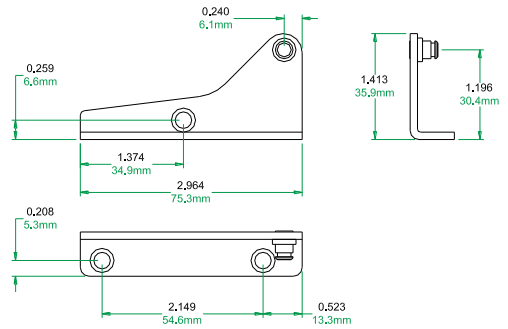

P/N	Material	Orientation
7039	SST	LH
7040	SST	RH
19039	STEEL	LH
19040	STEEL	RH

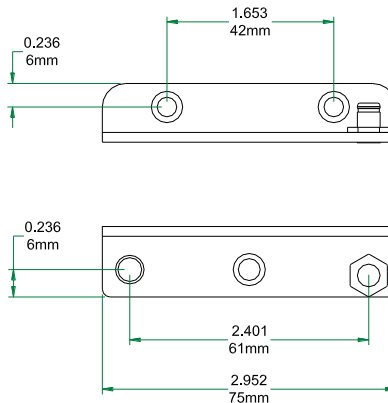

Operator Stud Brackets

P/N	Material	Orientation
70447	SST	Non Handed
190447	Steel	Non Handed

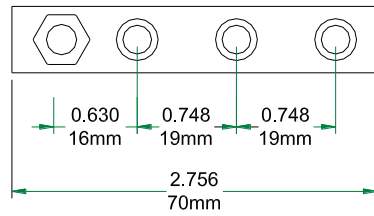
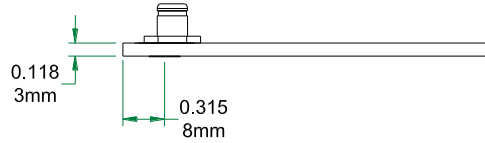

P/N	Material	Orientation
190448	Steel	Non Handed

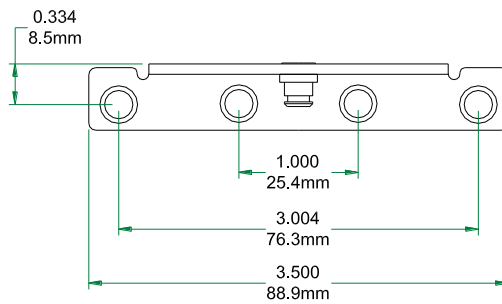
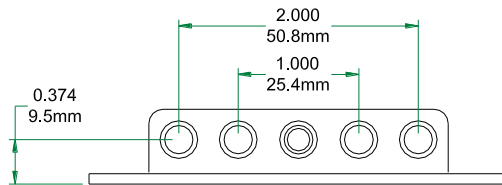



130-630-SC15 Eclipsed Scissor Awning Operator ; 190030/70030
Awning Track & Awning Track Sliding Device

Cover Closed

MATERIALS AND FINISH:

Die cast zinc base, and strengthened steel guide arms all with an ultra durable powder coat finish, protects against rust and UV rays.

Note: Operators come/w with Crank Handle

- A. Specify quantity desired. Minimum order 1 box and multiples thereof.
- B. **Packaging:** 20 operators / box
- C. **Weight:** see specification sheets for weight of box

ADDITIONAL COMPONENTS.

Recommended:

- Operator's Cover: 100/Box (10x10)
- Part Number:
- # 26081 = Ivory White
 - # 26080 = White
 - # 16090 = Beige
 - Awning Track 190030 (Steel) or
 - Awning Track 70030 (Stainless Steel)
 - Awning Track Sliding Device (2/operator)

Please refer to next page for Spec. and frame cut-out

LIFETIME WARRANTY

All Acme Window Hardware Ltd. Components are provided with a lifetime warranty, please see Warranty section for full details

Eclipse Scissor Awning Operator (Sill Mount)

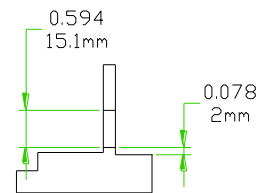
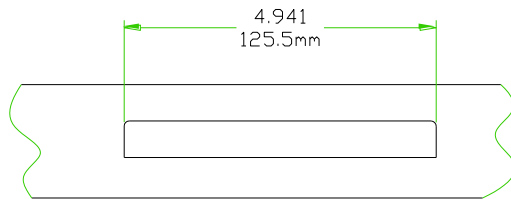
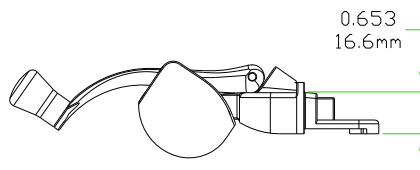
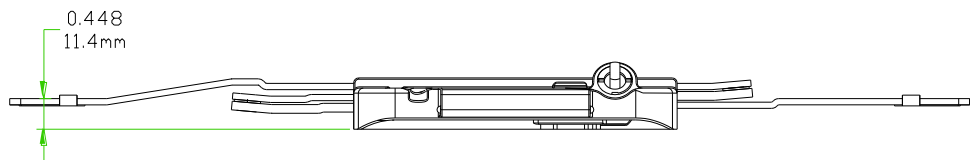
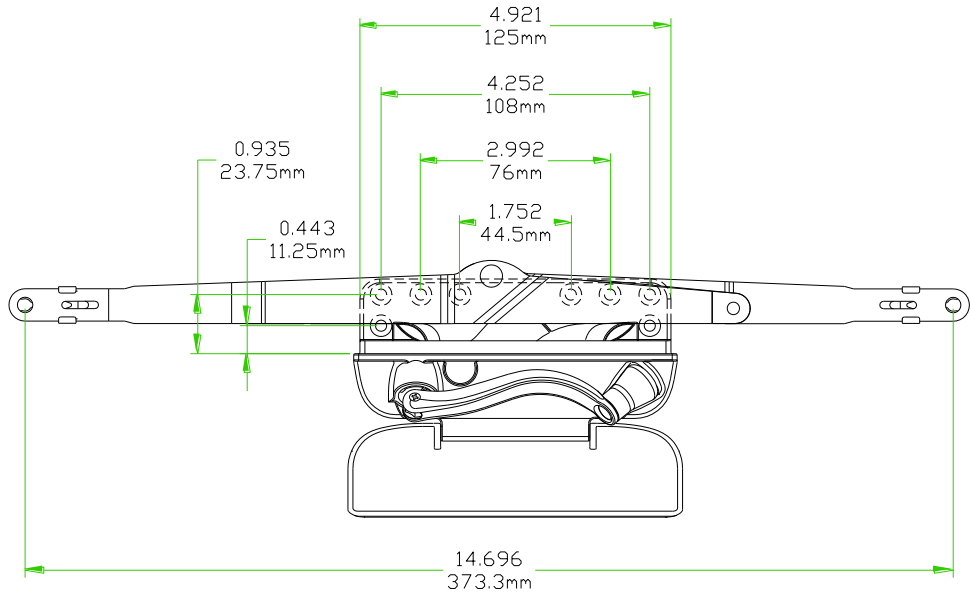

Profile Cut Out

ADDITIONAL COMPONENTS

Back Plate 19026

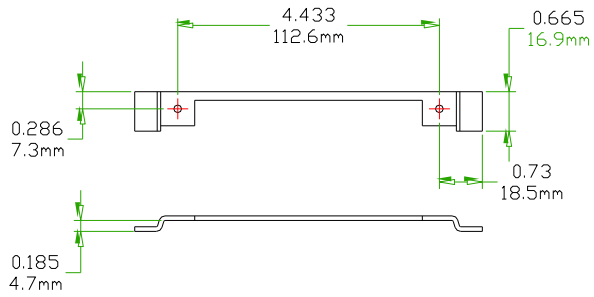

Track 190030 (Steel) / 70030 (Stainless Steel)

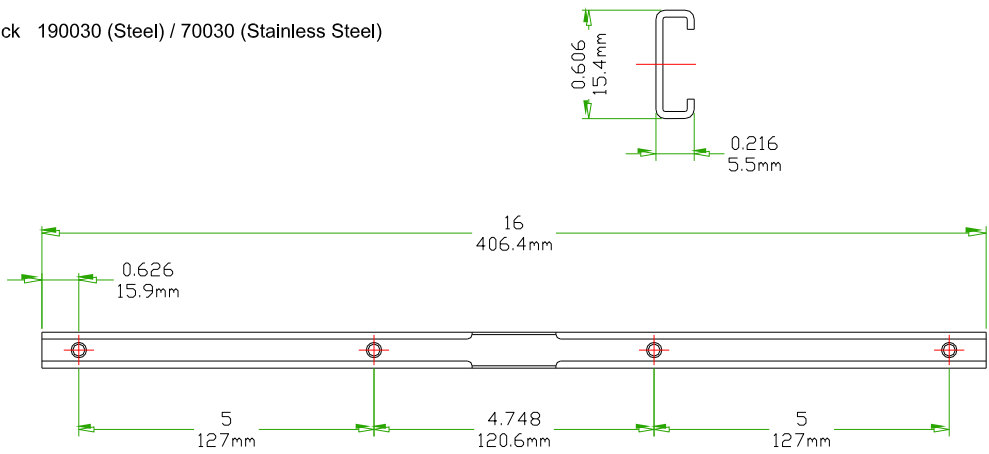

Sliding Device 20070

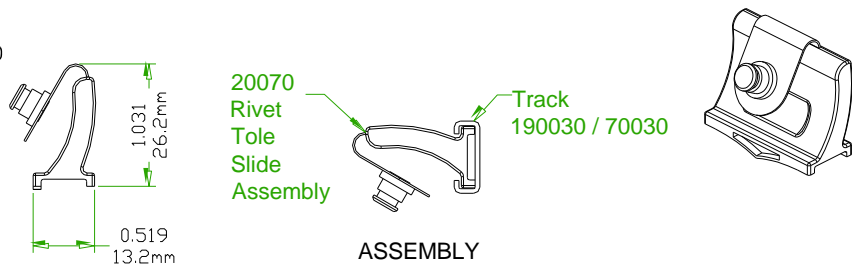

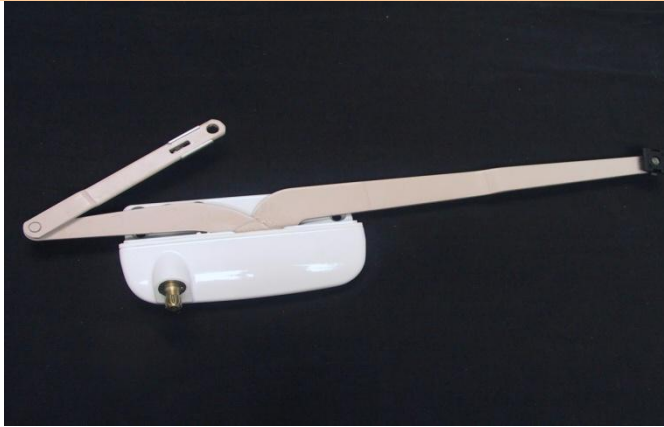

132626-R Dual Arm Operator (R/H) shown

MATERIALS AND FINISH:

Die cast zinc base, and strengthened steel guide arms all with an ultra durable powder coat finish, protects against rust and UV rays.

ORDERING INFORMATION

- Choose Operator type:
132666-R : Right Hand
132626-L: Left Hand

SELECT ADDITIONAL COMPONENTS.

Recommended:

- Crank Handles:
132059-Straight up ; 132060- Folding down
- Mounting Track:
70051 – Dual Track – SST - 367mm (14.49")
70052 – Dual Track – SST - 230mm (9.06")
- 19041 – Stud Bracket – L/H
- 19042 – Stud Bracket – R/H

- For details: please refer to Operator Accessories section

Packaging:

- Qty/Box: 20/Pcs
- Weight: 25Kg/box

STANDARD COLORS:

Available colors are white and beige, Custom colors available upon request (some Conditions may apply).

Color Code:

- 130-xxx = IvoryWhite
- 132-xxx = White
- 136-xxx = Beige

Please refer to next page for Spec. and frame cut-out

LIFETIME WARRANTY

All Acme Window Hardware Ltd. Components are provided with a lifetime warranty, please see Warranty section for full details

Ivory White:

- 130626-R Dual Arm Operator R/H
- 130626-L Dual Arm Operator L/H

WHITE:

- 132626-R Dual Arm Operator R/H
- 132626-L Dual Arm Operator L/H

BEIGE:

- 136626-R Dual Arm Operator R/H
- 136626-L Dual Arm Operator L/H

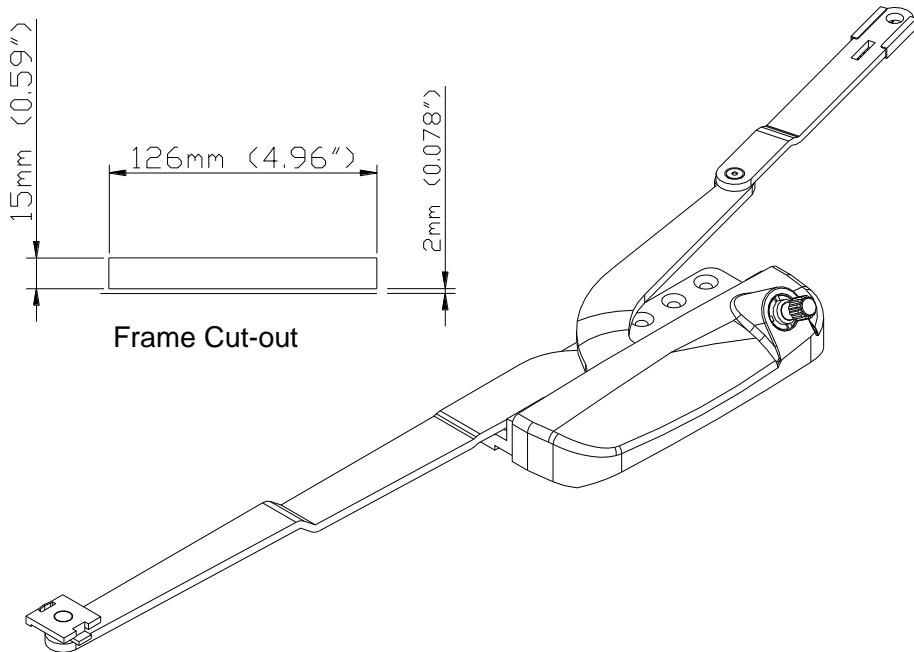

ADDITIONAL COMPONENTS – RECOMMENDED:

- 70051 – Dual Track - SST A = 367mm (14.49")
- 70052 – Dual Track - SST A = 230mm (9.06")
- 19041 – Stud Bracket – L/H
- 19042 – Stud Bracket – R/H

Please refer to Operators Accessories For More Options

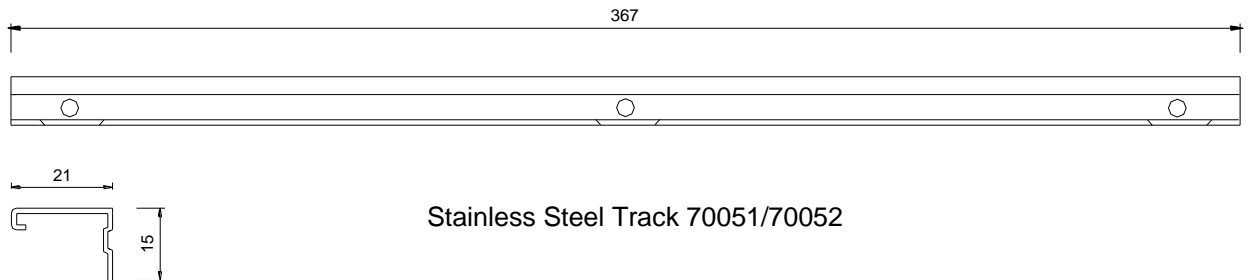

Stainless Steel Track 70051/70052



130-905-01 Grand Case Dyad Operator (L/H) shown

MATERIALS AND FINISH:

Die cast zinc base, and strengthened steel guide arms all with an ultra durable powder coat finish, protects against rust and UV rays.

ORDERING INFORMATION

Choose Operator type:

- 132-905-00-R : Right Hand
- 132-905-01-L: Left Hand

ADDITIONAL COMPONENTS

Recommended:

- Crank Handles: 132059-Straight up ; 132060-Folding down
- Stud Brackets: Please refer to Operator Accessories section

Packaging:

- Qty/Box: 20/Pcs
- Weight: 25Kg/box

STANDARD COLORS:

Available colors are white and beige, custom colors available upon request (some conditions may apply).

Color Code:

- 130-xxx = IvoryWhite
- 132-xxx = White
- 136-xxx = Beige

Please refer to next page for Spec. and frame cut-out

LIFETIME WARRANTY

All Acme Window Hardware Ltd. Components are provided with a lifetime warranty, please see Warranty section for full details

Grand Case Dyad Operators

Standard Colors:

- 130-xxx = IvoryWhite
- 132-xxx = White
- 136-xxx = Beige

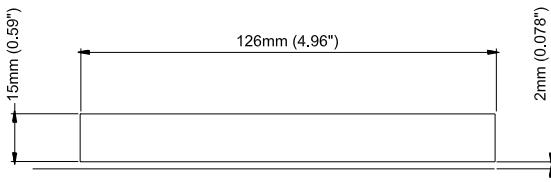
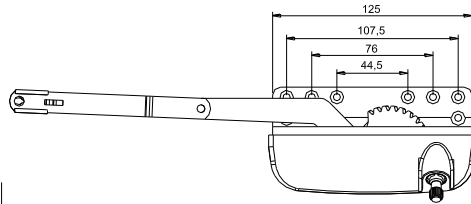
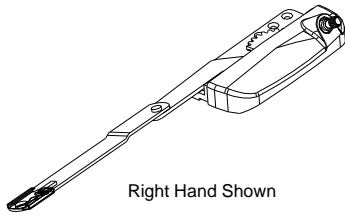

Frame Cut-out Details

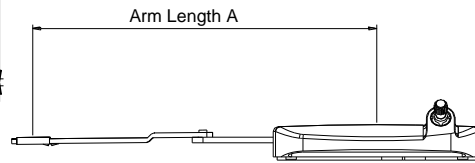

Product Name	P/N	Arm Length A	Product Name	P/N	Arm Length A
Grand Case Dyad, Right Hand	132-905-00	229.8(9.05")	Grand Case Dyad, Right Hand	132-879-00	223.27(8.79")
Grand Case Dyad, Left Hand	132-905-01	229.8(9.05")	Grand Case Dyad, Left Hand	132-879-01	223.27(8.79")

Grand Case Split Arm Operators

Color Code:

- 130-xxx = IvoryWhite
- 132-xxx = White
- 136-xxx = Beige

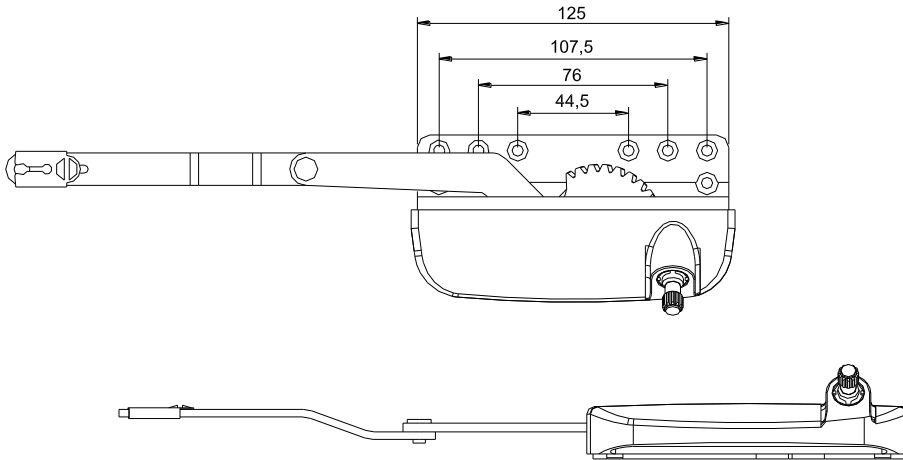

Product Name	P/N
Grand Case Split Arm Operator - R/H	132-606-00
Grand Case Split Arm Operator - L/H	132-606-01

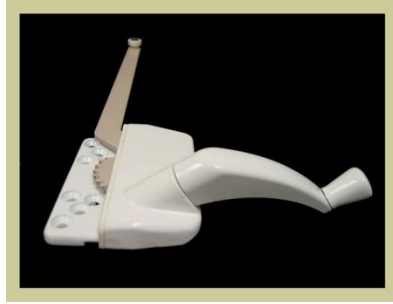

132-075-00 – 7 1/2" Single Arm Operator (R/H) shown with 132059 Operator Crank

MATERIALS AND FINISH:

Die cast zinc base, and strengthened steel guide arms all with an ultra durable powder coat finish, protects against rust and UV rays.

ORDERING INFORMATION:

A. SINGLE ARM OPERATOR

- Specify orientation, indicated by last 2 digits of part number.
 - 00 for right
 - 01 for left hand
- Choose desired operator size:
- 7.1/2"; 9.1/2" and 13.1/2" (indicate by part number).

B. SPECIFY QUANTITY DESIRED.

Minimum order 1 box and multiples thereof.

Packaging: 20 operators / box

Weight: see specification sheets for weight of box

SELECT ADDITIONAL COMPONENTS.

Recommended:

- Crank Handles: 132059-Straight up ; 132060-Folding down
- Mounting Track: 190040
- For details: please refer to Operator Accessories section

Please refer to next page for Spec. and frame cut-out

STANDARD COLORS:

Available colors are white and beige, custom colors available upon request (some conditions may apply).

Color Code:

- 130-xxx = Ivory White
- 132-xxx = White
- 136-xxx = Beige

LIFETIME WARRANTY

All Acme Window Hardware Ltd. Components are provided with a lifetime warranty, please see Warranty section for full details

IVORY WHITE:

- 130-075-00 R/H - Single Arm Operator 7 1/2" A = 190.5mm (7.5")
- 130-075-01 L/H - Single Arm Operator 7 1/2" A = 190.5mm (7.5")
- 130-095-00 R/H - Single Arm Operator 9 1/2" A = 241.3mm (9.5")
- 130-095-01 L/H - Single Arm Operator 9 1/2" A = 241.3mm (9.5")
- 130-135-00 R/H - Single Arm Operator 13 1/2" A = 343mm (13.5")
- 130-135-01 L/H - Single Arm Operator 13 1/2" A = 343mm (13.5")

WHITE:

- 132-075-00 R/H - Single Arm Operator 7 1/2" A = 190.5mm (7.5")
- 132-075-01 L/H - Single Arm Operator 7 1/2" A = 190.5mm (7.5")
- 132-095-00 R/H - Single Arm Operator 9 1/2" A = 241.3mm (9.5")
- 132-095-01 L/H - Single Arm Operator 9 1/2" A = 241.3mm (9.5")
- 132-135-00 R/H - Single Arm Operator 13 1/2" A = 343mm (13.5")
- 132-135-01 L/H - Single Arm Operator 13 1/2" A = 343mm (13.5")

BEIGE:

- 136-075-00 R/H - Single Arm Operator 7 1/2" A = 190.5mm (7.5")
- 136-075-01 L/H - Single Arm Operator 7 1/2" A = 190.5mm (7.5")
- 136-095-00 R/H - Single Arm Operator 9 1/2" A = 241.3mm (9.5")
- 136-095-01 L/H - Single Arm Operator 9 1/2" A = 241.3mm (9.5")
- 136-135-00 R/H - Single Arm Operator 13 1/2" A = 343mm (13.5")
- 136-135-01 L/H - Single Arm Operator 13 1/2" A = 343mm (13.5")

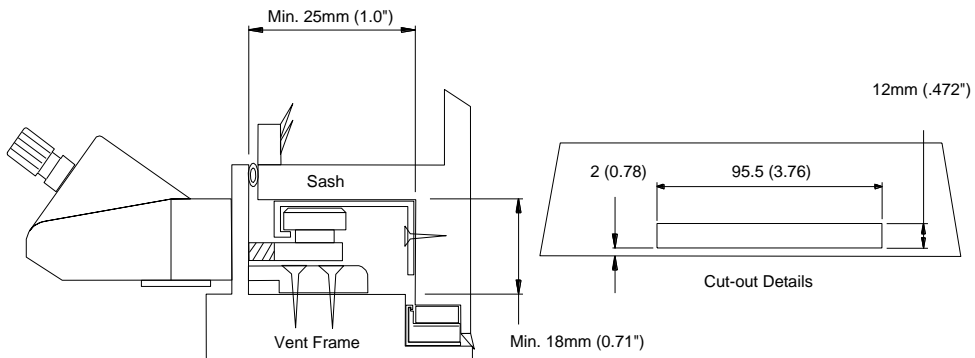
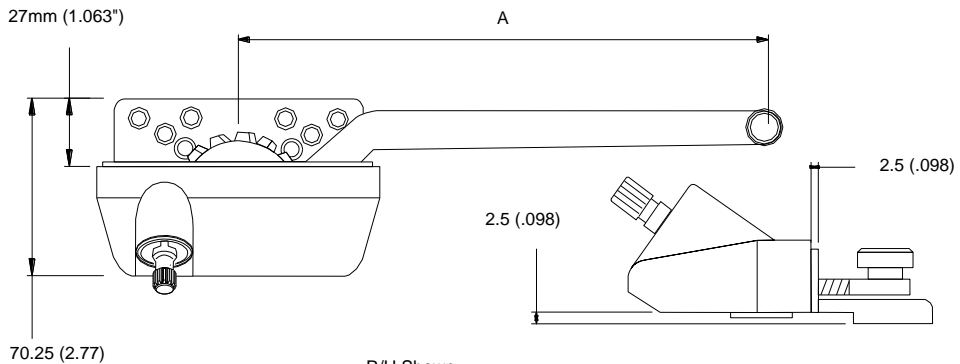

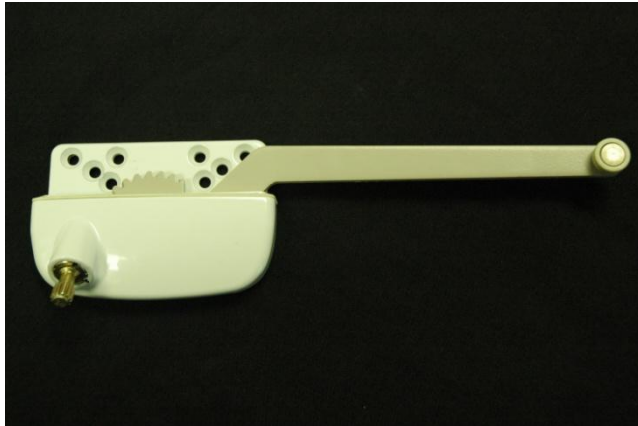

SINGLE ARM OPERATORS "Z" SERIES

132105-RZ75 – Single Arm Operator (R/H) shown

MATERIALS AND FINISH:

Die cast zinc base, and strengthened steel guide arms all with an ultra durable powder coat finish, protects against rust and UV rays.

ORDERING INFORMATION

- Choose Operator type:
 - 132105-RZ75 - Right Hand (7.1/2")
 - 132105-LZ75 - Left Hand (7.1/2")
 - 132105-RZ95 - Right Hand (9.1/2")
 - 132105-LZ95 - Left Hand (9.1/2")
 - 132105-RZ135 - Right Hand (13.1/2")
 - 132105-LZ135 - Left Hand (13.1/2")

SELECT ADDITIONAL COMPONENTS.

Recommended:

- Crank Handles: 132059-Straight up ; 132060-Folding down
- Mounting Track: 190040
- For details: please refer to Operator Accessories section

Packaging: 20 operators / box

Weight: see specification sheets for weight of box

SELECT ADDITIONAL COMPONENTS.

Recommended:

- Crank Handles: 132059-Straight up ; 132060- Folding down
- Mounting Track: 190040
- For details: please refer to Operator Accessories section

Please refer to next page for Spec. and frame cut-out

STANDARD COLORS:

Available colors are white and beige, custom colors available upon request (some conditions may apply).

Color Code:

- 130-xxx = Ivory White
- 132-xxx = White
- 136-xxx = Beige

LIFETIME WARRANTY

All Acme Window Hardware Ltd. Components are provided with a lifetime warranty, please see Warranty section for full details

IVORY WHITE: (130)

- 130105-RZ75 - Right Hand (7.1/2") A =190.5mm (7.5")
- 130105-LZ75 - Left Hand (7.1/2") A =190.5mm (7.5")
- 130105-RZ95 - Right Hand (9.1/2") A =241.3mm (9.5")
- 130105-LZ95 - Left Hand (9.1/2") A =241.3mm (9.5")
- 130105-RZ135 - Right Hand (13.1/2") A =343mm (13.5")
- 130105-LZ135 - Left Hand (13.1/2") A =343mm (13.5")

WHITE: (132)

- 132105-RZ75 - Right Hand (7.1/2") A =190.5mm (7.5")
- 132105-LZ75 - Left Hand (7.1/2") A =190.5mm (7.5")
- 132105-RZ95 - Right Hand (9.1/2") A =241.3mm (9.5")
- 132105-LZ95 - Left Hand (9.1/2") A =241.3mm (9.5")
- 132105-RZ135 - Right Hand (13.1/2") A =343mm (13.5")
- 132105-LZ135 - Left Hand (13.1/2") A =343mm (13.5")

BEIGE CODE: (136)

136105-RZxx
And so on.....

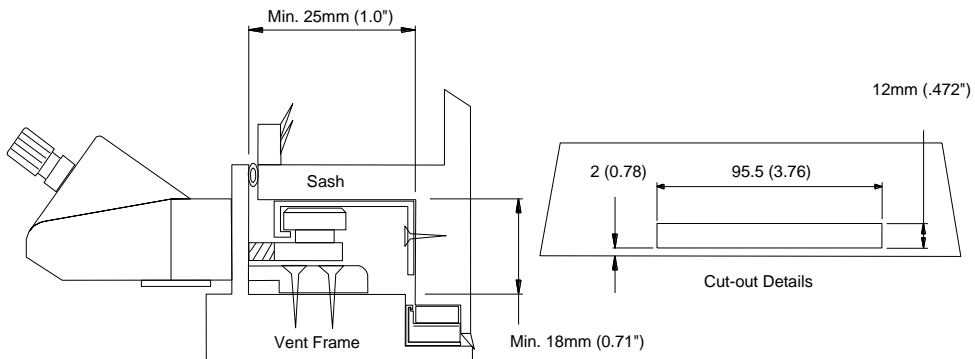
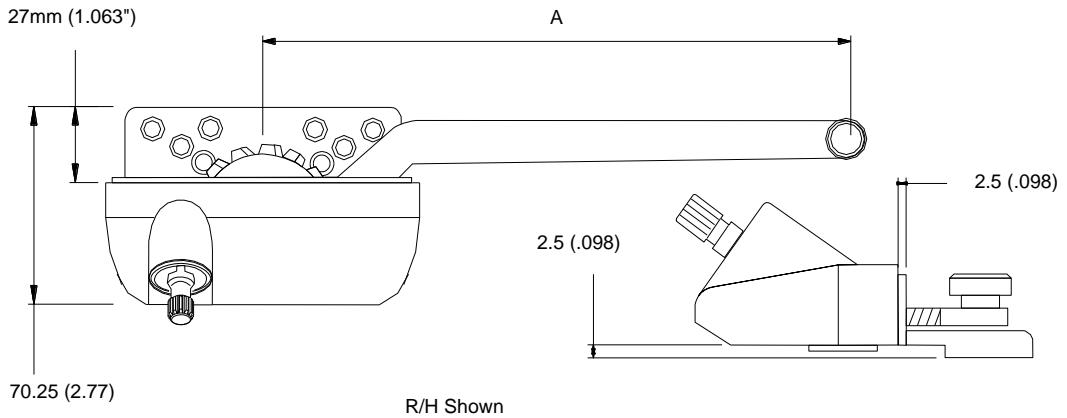



132-0120 – 12” Awning Operator shown with 132059 Operator Crank

MATERIALS AND FINISH:

Die cast zinc base, and strengthened steel guide arms all with an ultra durable powder coat finish, protects against rust and UV rays.

STANDARD COLORS:

Available colors are white and beige, custom colors available upon request (some conditions may apply).

ORDERING INFORMATION

A. Choose Operator type:

AWNING OPERATOR

- Choose desired operator size: 12” - 16” or 21” (indicate by part number).

Color Code:

- 130-xxx = Ivory White
- 132-xxx = White
- 136-xxx = Beige

Please refer to next page for Spec. and frame cut-out

B. Specify quantity desired. Minimum order 1 box and multiples thereof.

Packaging: 20 operators / box

Weight: see specification sheets for weight of box

ADDITIONAL COMPONENTS.

Recommended:

- Crank Handles: 132059-Straight up ; 132060-Folding down
- Center Hook: 1901270
- For details: please refer to Operator Accessories section

LIFETIME WARRANTY

All Acme Window Hardware Ltd. Components are provided with a lifetime warranty, please see Warranty section for full details

IVORY WHITE:

- 130-0120 Awning Operator 12" A = 305mm (12")
- 130-0160 Awning Operator 16" A = 406.5mm (16")
- 130-0210 Awning Operators 21" A = 533.4mm (21")

WHITE:

- 132-0120 Awning Operator 12" A = 305mm (12")
- 132-0160 Awning Operator 16" A = 406.5mm (16")
- 132-0210 Awning Operators 21" A = 533.4mm (21")

BEIGE:

- 136-0120 Awning Operator 12" A = 305mm (12")
- 136-0160 Awning Operator 16" A = 406.5mm (16")
- 136-0210 Awning Operators 21" A = 533.4mm (21")

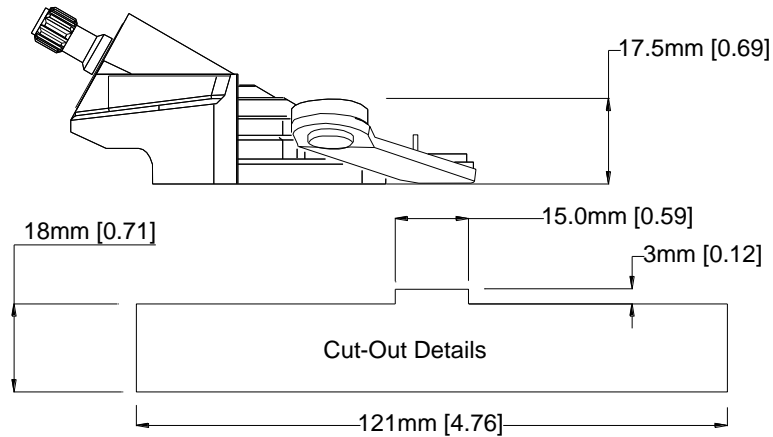
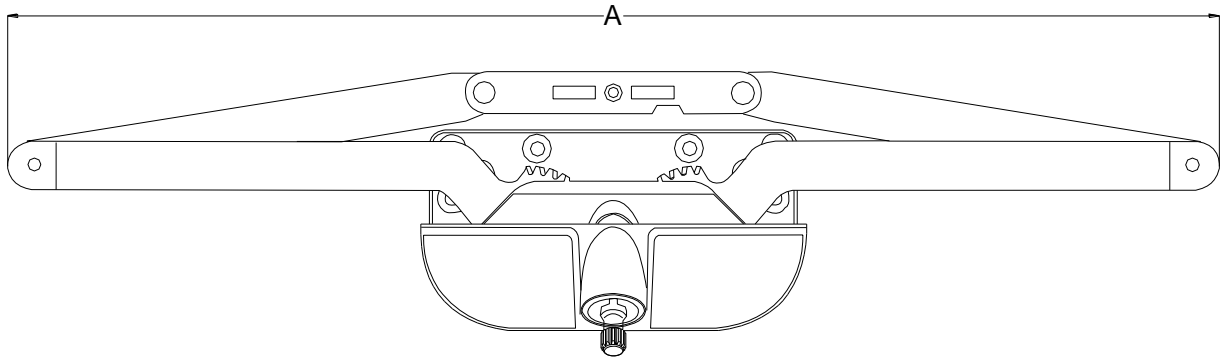



1901270 – Center Hook



132060 – Folding Crank



132059 – Operator Crank

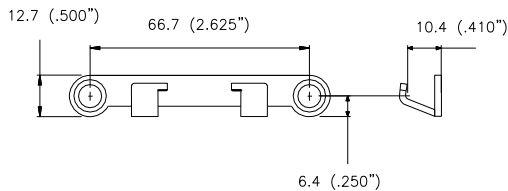

Sash Hook 19080 - Adjustable

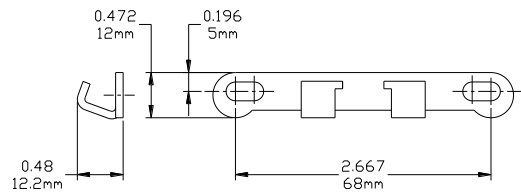

MATERIALS AND FINISH:

Die cast zinc Operator Cranks, available in white or beige, Mounting Tracks and Center Hooks made of strengthened steel all with an Ultra durable powder coat finish, protects Against rust and UV rays.

ORDERING INFORMATION

1. Choose desired components (indicate by part number.)
2. Specify quantity desired. Minimum order 1 box and multiples thereof.

Packaging: 20 Operator Cranks/ box

Weight: 17Kg / box

Packaging: 100 Mounting Tracks / box

Weight: 10Kg / box

Packaging: 200 Center Hooks /box

Weight: 4kg/box

STANDARD COLORS:

Available colors are white and beige, custom colors available upon request (some conditions may apply).

Color Code:

- 130-xxx = Ivory White
- 132-xxx = White
- 136-xxx = Beige

LIFETIME WARRANTY

All Acme Window Hardware Ltd. Components are provided with a lifetime warranty, please see Warranty section for full details

IVORY WHITE:

- 130059 – Operator Crank Handle
- 130060 – Folding Crank Handle

WHITE:

- 132059 – Operator Crank Handle
- 132060 – Folding Crank Handle

BEIGE:

- 136059 – Operator Crank Handle
- 136060 – Folding Crank Handle

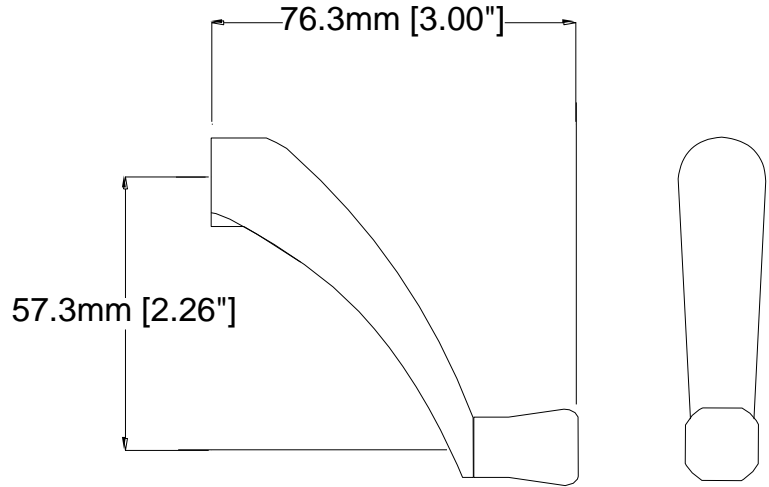

- 190040 – Mounting Track 4 Holes

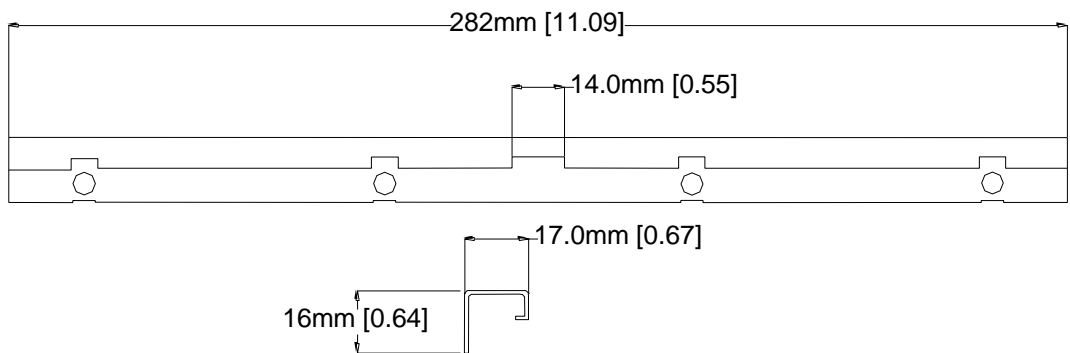

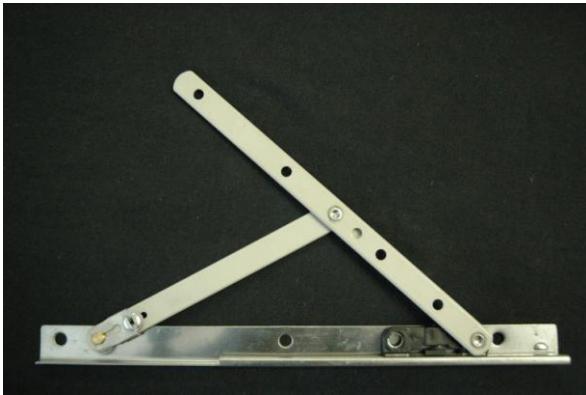

19010-01 – 10” Adjustable Hinge
(L/H Shown)



7010-01 – 10” Stainless Steel - Adjustable Hinge
(L/H Shown)

MATERIALS AND FINISHING:

All Hinges are stainless steel track, rivets, and shoe core. Strengthened steel support arms with an ultra durable powder coat finish, protects against rust and UV rays. Also 100% Stainless Steel Hinges are available

ORDERING INFORMATION

1. Choose desired hinge size (indicate by part number). 10” comes separate (arm and track), sizes 14”, 18” and 24” come assembled
2. Specify orientation, indicated by last 2 digits of part number. (determined from exterior)
 - 00 for right hand
 - 01 for left hand

3. Specify quantity desired. Minimum order 1 box and multiples thereof.

Packaging: 100 hinges / box

Weight: see specification sheets
for weight of box

LIFETIME WARRANTY

All Acme Window Hardware Ltd. Components are provided with a lifetime warranty, please see Warranty section for full details

10" Standard Two Bar Hinge

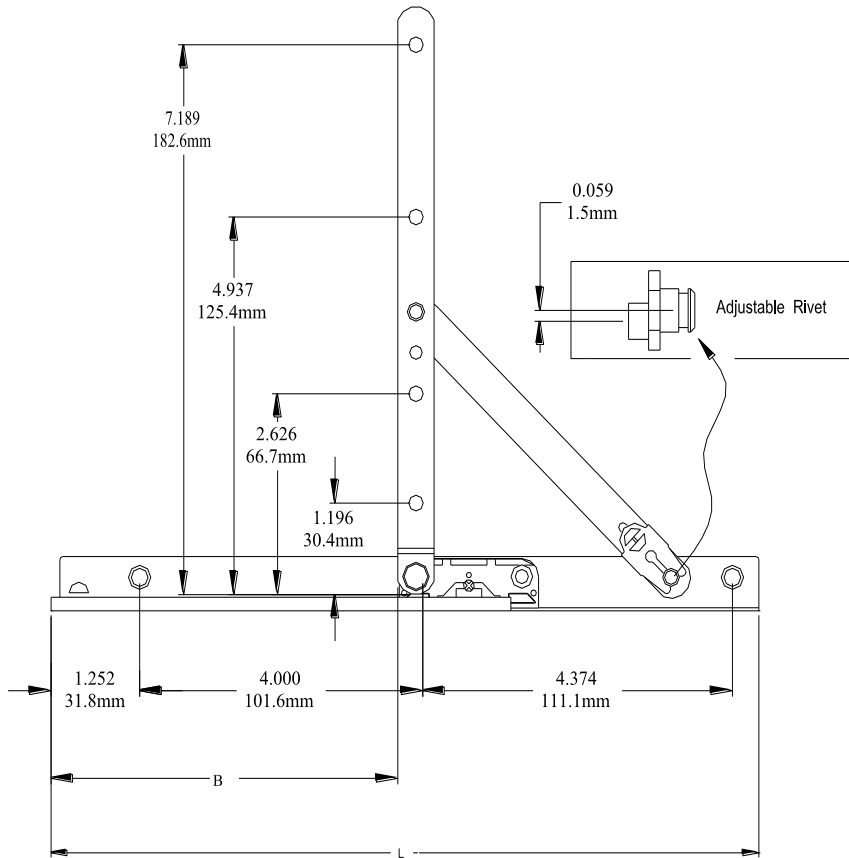

Right Hand Shown

Part Number	Product Name	" B "	" L "	Material	Orientation
19010-SAC-01	Two Bar Hinge , 10" , Standard , Adjustable , Clip-on , LH	4.905"	10"	Steel	LH
19010-SAC-00	Two Bar Hinge , 10" , Standard , Adjustable , Clip-on , RH	4.905"	10"	Steel	RH
7010-SAC-01	Two Bar Hinge , 10" , Standard , Adjustable , Clip-on , SST , LH	4.905"	10"	SST	LH
7010-SAC-00	Two Bar Hinge , 10" , Standard , Adjustable , Clip-on , SST , RH	4.905"	10"	SST	RH

10" E Gress Two Bar Hinge

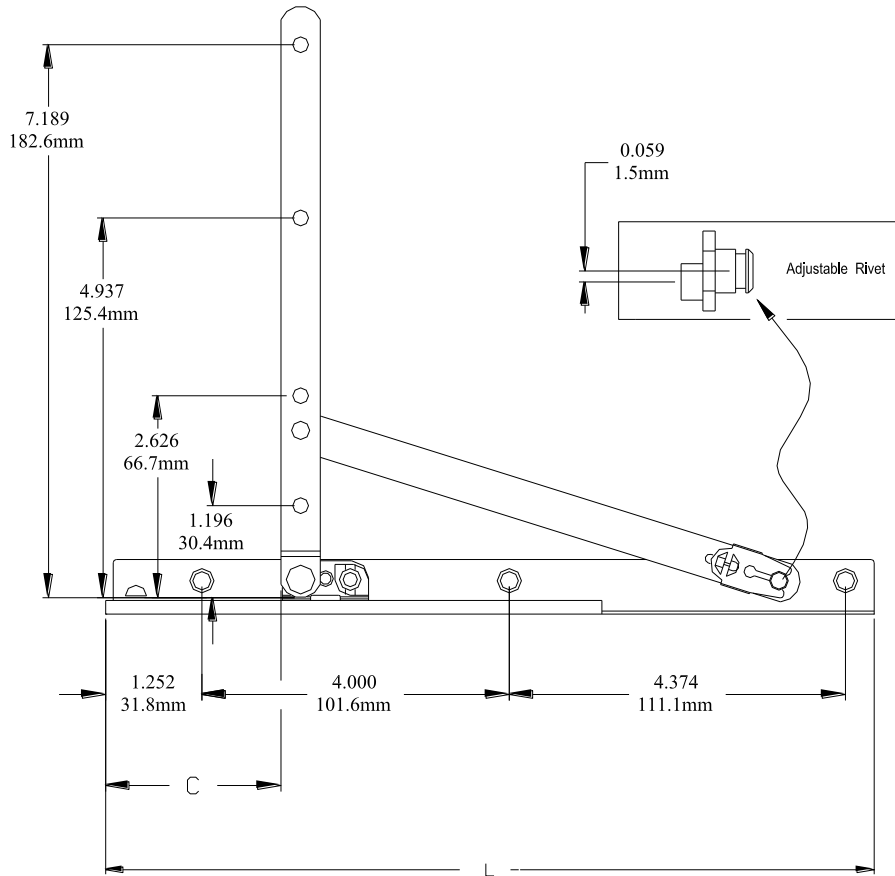

Right Hand Shown

Part Number	Product Name	" B "	" L "	Material	Orientation
19010-EAC-01	Two Bar Hinge , 10" , E-gress , Adjustable , Clip-on , LH	2.279"	10"	Steel	LH
19010-EAC-00	Two Bar Hinge , 10" , E-gress , Adjustable , Clip-on , RH	2.279"	10"	Steel	RH
7010-EAC-01	Two Bar Hinge , 10" , E-gress , Adjustable , Clip-on , SST , LH	2.279"	10"	SST	LH
7010-EAC-00	Two Bar Hinge , 10" , E-gress , Adjustable , Clip-on , SST , RH	2.279"	10"	SST	RH

13" Standard Two Bar Hinge

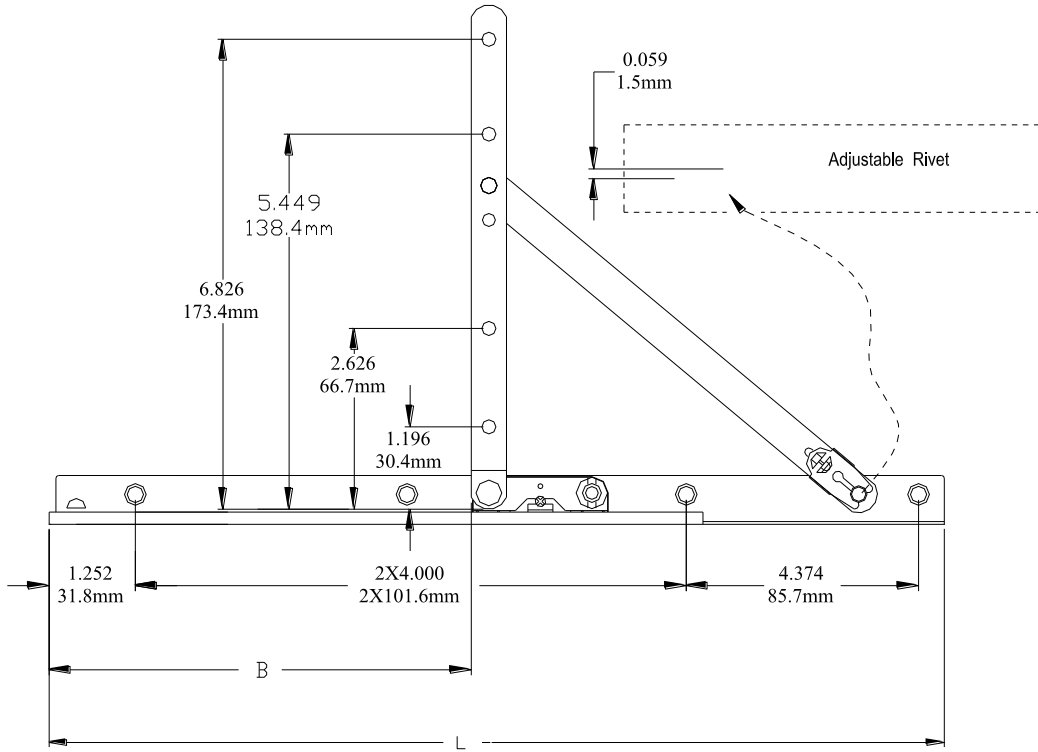

Right Hand Shown

PART NUMBER	PRODUCT NAME	" C "	" L "	MATERIAL	Oreintation
19013-SAC-01	13" Adjustable Hinge, Standard, Clip-On	6.130"	13"	Steel	LH
19013-SAC-00	13" Adjustable Hinge, Standard, Clip-On	6.130"	13"	Steel	RH
7013-SAC-01	13" Adjustable Hinge, Standard, Clip-On	6.130"	13"	SST	LH
7013-SAC-00	13" Adjustable Hinge, Standard, Clip-On	6.130"	13"	SST	RH

13" E Gress Two Bar Hinge

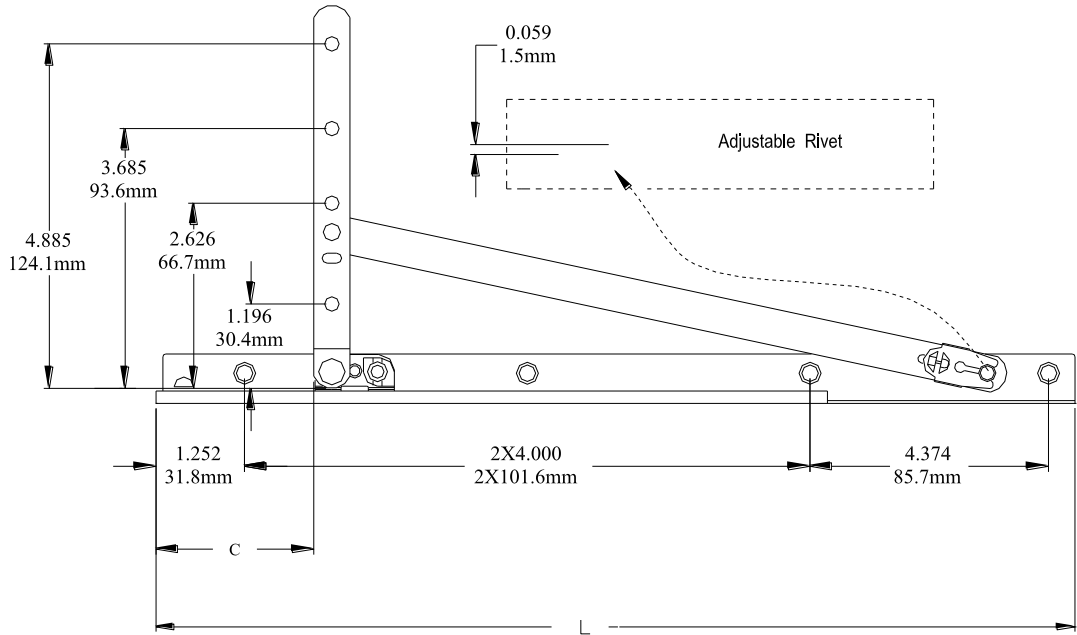

Right Hand Shown

PART NUMBER	PRODUCT NAME	" C "	" L "	MATERIAL	Orientation
19013-EAC-01	13" Adjustable Hinge, E Gress, Clip-On	2.232"	13"	Steel	LH
19013-EAC-00	13" Adjustable Hinge, E Gress, Clip-On	2.232"	13"	Steel	RH
7013-EAC-01	13" Adjustable Hinge, E Gress, Clip-On	2.232"	13"	SST	LH
7013-EAC-00	13" Adjustable Hinge, E Gress, Clip-On	2.232"	13"	SST	RH

14" Standard Two Bar Hinge

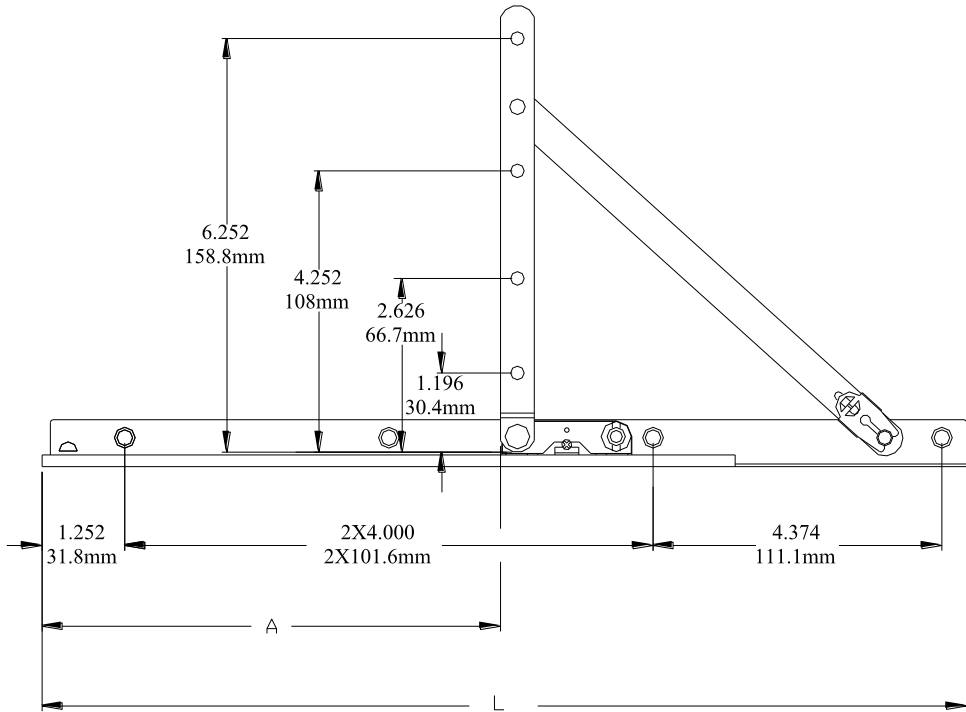

Right Hand Shown

Part Number	Product Name	" B "	" L "	Material	Orientation
19014-SNC-01	14" Non-Adjustable Hinge, Standard, Clip-On	6.941"	14"	Steel	LH
19014-SNC-00	14" Non-Adjustable Hinge, Standard, Clip-On	6.941"	14"	Steel	RH
7014-SNC-01	14" Non-Adjustable Hinge, Standard, Clip-On	6.941"	14"	SST	LH
7014-SNC-00	14" Non-Adjustable Hinge, Standard, Clip-On	6.941"	14"	SST	RH

18" Standard Two Bar Hinge

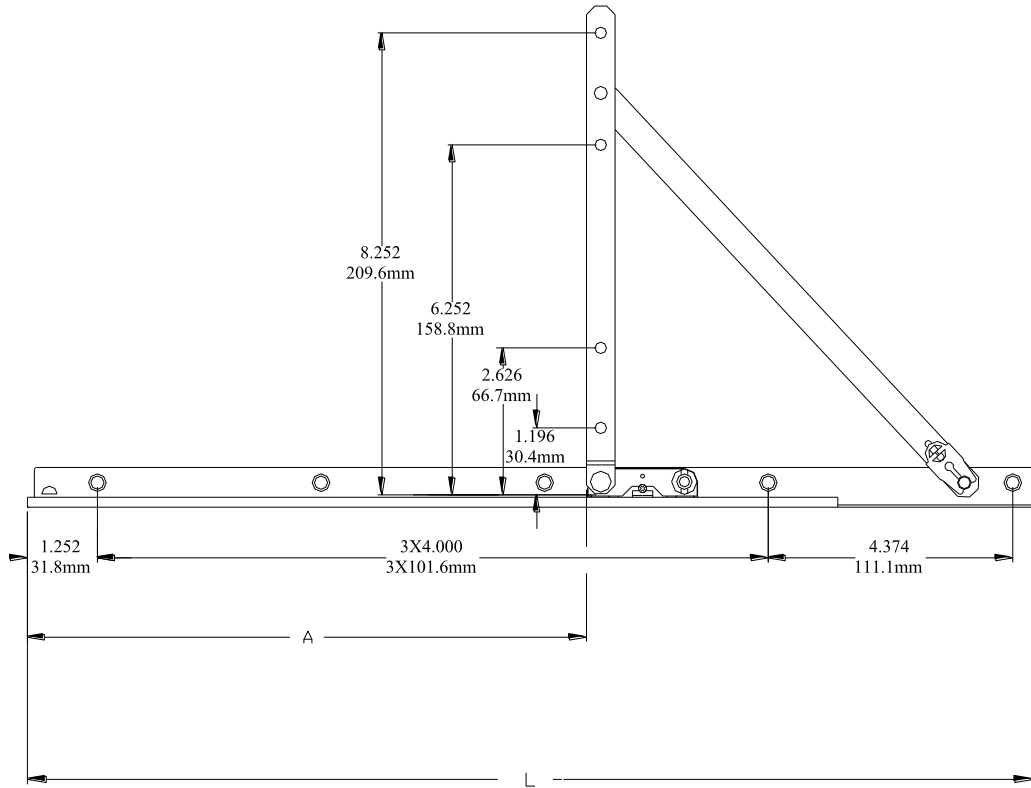

Right Hand Shown

Part Number	Product Name	" B "	" L "	Material	Orientation
19018-SNC-01	18" Non-Adjustable Hinge, Standard, Clip-On	10"	18"	Steel	LH
19018-SNC-00	18" Non-Adjustable Hinge, Standard, Clip-On	10"	18"	Steel	RH
7018-SNC-01	18" Non-Adjustable Hinge, Standard, Clip-On	10"	18"	SST	LH
7018-SNC-00	18" Non-Adjustable Hinge, Standard, Clip-On	10"	18"	SST	RH

22" Standard Two Bar Hinge

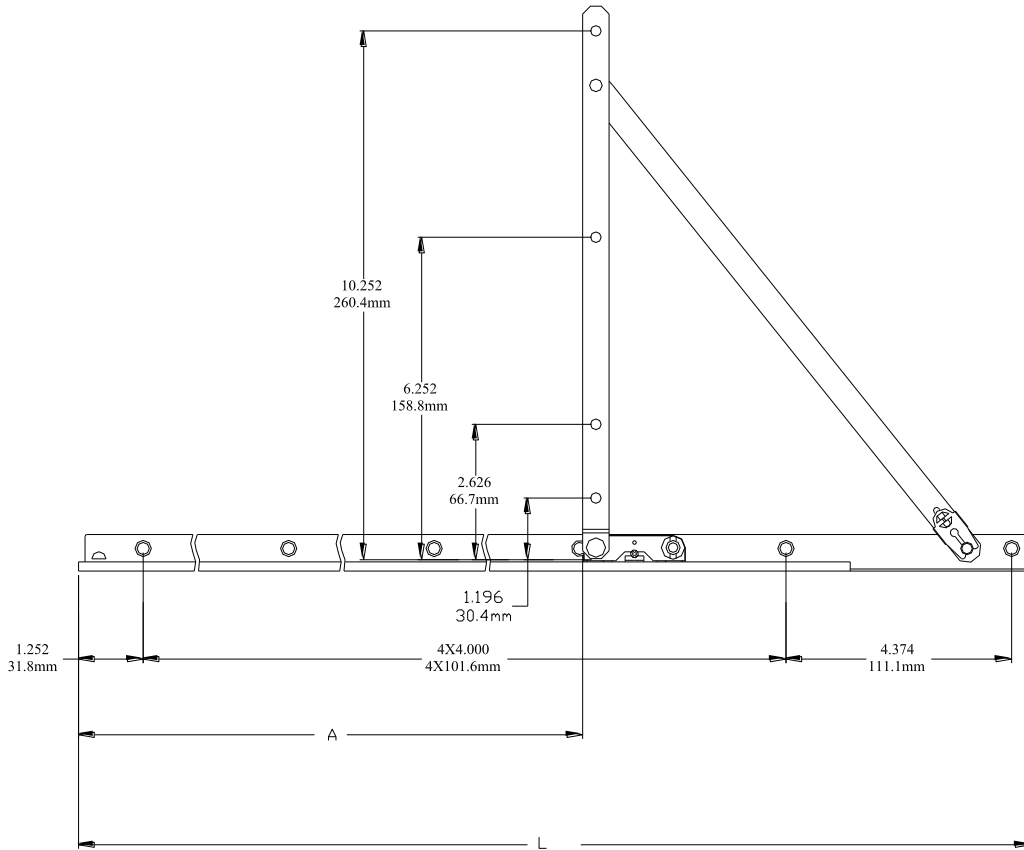

Right Hand Shown

Part Number	Product Name	" B "	" L "	Material	Orientation
19022-SNC-01	22" Non-Adjustable Hinge, Standard, Clip-On	13.311"	22"	Steel	LH
19022-SNC-00	22" Non-Adjustable Hinge, Standard, Clip-On	13.311"	22"	Steel	RH
7022-SNC-01	22" Non-Adjustable Hinge, Standard, Clip-On	13.311"	22"	SST	LH
7022-SNC-00	22" Non-Adjustable Hinge, Standard, Clip-On	13.311"	22"	SST	RH

26" Standard Two Bar Hinge

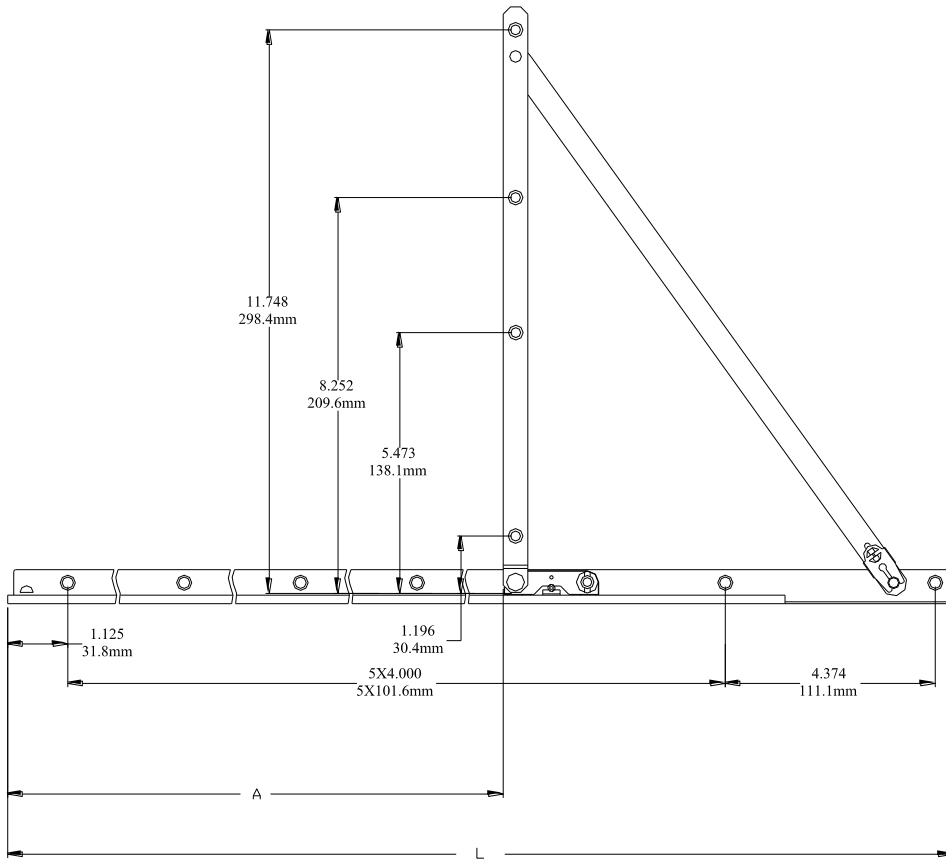

Right Hand Shown

Part Number	Product Name	" B "	" L "	Material	Orientation
19026-SNC-01	26" Non-Adjustable Hinge, Standard, Clip-On	16.626"	26"	Steel	LH
19026-SNC-00	26" Non-Adjustable Hinge, Standard, Clip-On	16.626"	26"	Steel	RH
7026-SNC-01	26" Non-Adjustable Hinge, Standard, Clip-On	16.626"	26"	SST	LH
7026-SNC-00	26" Non-Adjustable Hinge, Standard, Clip-On	16.626"	26"	SST	RH

Snubber

190010

